



# PRIMNER

## VERTICAL MACHINING CENTERS

PRECISE · DYNAMIC · RELIABLE





# **PRIMINER**

**The Company**

**DESIGNED IN  
GERMANY  
MADE IN CHINA**





PRIMINER

PRIMINER

PRIMINER





## We stay up to date

“Only employees which are regular trained and involved in the development of our production process can understand the requirements of present and future as a whole.” According to Mr. Kaehlcke GM of Priminer Germany. “This is the case for our German and China team members. We have an intensive exchange program between our two major spots, additional to our permanent training course at our global leading sub-suppliers.”







# HOW WE DO IT

Consequent QC-management according to international norms, a highly motivated team of specialists, advantages of serial production and reliable top sub-suppliers with global leading positions are columns of our success. An open and result-oriented company culture through all levels is the basement for a permanent high level of our reliability and products.



## Our Team

International, competent, highly motivated and always open for new ideas... This is our team. The cooperate culture is a mirror of these attitudes. Our management has got a “open ear” from bottom to top and we practise flat hierarchy.

# PRIMIN





PRIMINER



PRIMER Global TEAM



The background of the entire page is a photograph of a CNC machine. At the top, a white sign with black and red text shows a 3D coordinate system with axes labeled +X, -X, +Y, -Y, +Z, and -Z. Below this, a large green banner contains the main title. In the lower-left, a green triangle contains the sub-header and a paragraph of text. The rest of the image shows the dark, industrial structure of the machine, including a blue and orange flexible cable and a small orange tool at the bottom right.

# OUR KNOW-HOW FOR YOUR BUSINESS

## Technology & Know-how

We think and plan the future already now. A growing in-house R&D department with experienced engineers which develop our machine concepts are our warrantor that we are prepared for the upcoming trends of the machine tools business. We are listening to the market. Flexibility in the matter of CNC controllers is for us a must, here we only go with the market leaders. Without any compromise!





# U500-5X · U800-5X



- Gantry design
- Torque motor direct drive rotary table
- Dual drive system with two ballscrews on Y axis to ensure the best dynamic.
- Compact design with minimum floor plan area

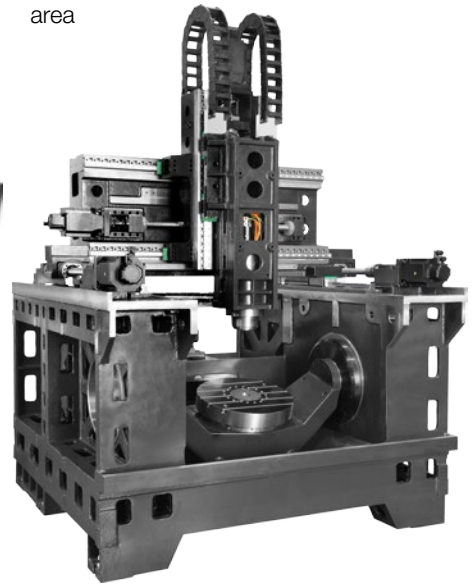

Technical Specifications		U500-5X			U800-5X
Table					
Max. workpiece diameter	mm	Φ700			Φ1000
Table size	mm	Φ500			Φ800x700
T-slot (width x number x distance)	mm	14 x 5 x 80			14x7x100
Max. load	kg	500			1000
Travel					
X/Y/Z Travel	mm	700/650/450			1000/1000/600
A/C Travel	deg	+30° ~ -110°/360°			
Spindle					
Spindle taper	-	HSK A63	HSK A63	HSK E50	HSK A63
Spindle motor power	kW	21/26	20/24	15/18	30/36
Spindle motor torque	Nm	67/86	48/58	14/17.3	100/120
Spindle speed	rpm	18000	20000	36000	16000
Spindle nose to table	mm	135-585	110-560	110-560	180-780
Feed					
Rapid feed X/Y/Z	m/min	36			48/48/24
Rotation speed A/C	rpm	100/170			100/100
Cutting speed	mm/min	1-12000			1-12000
Tool changer					
Number of tools	pcs	32			40
Max. tool length	mm	250			300
Max. tool diameter	mm	Φ63			Φ78
Max. tool weight	kg	4			8
Accuracy(VDI 3441 Full travel)					
Positioning accuracy	mm	0.006 (X/Y/Z) 5/3 arc-sec (A/C)			0.008 (X/Y/Z) 8/6 arc-sec (A/C)
Repeatability accuracy	mm	0.003 (X/Y/Z) 2.5/2 arc-sec (A/C)			0.004 (X/Y/Z) 4/3 arc-sec (A/C)
Dimensions & Weight					
Dimensions	mm	3560×3380×2995			4100×3800×3600
Weight	kg	10000			15000

## Standard configuration

- ✓ Direct drive rotary table
- ✓ A axis with dual direct drive(U800-5X)
- ✓ Built-in spindle HSK A63 20000 rpm(U500-5X)
- ✓ Built-in spindle HSK A63 16000 rpm(U800-5X)
- ✓ 32 pockets tool changer(U500-5X)
- ✓ 40 pockets tool changer(U800-5X)
- ✓ Chain type chip conveyor
- ✓ Air-conditioned electrical cabinet
- ✓ High precision spindle water cooler
- ✓ Linear scales on X/Y/Z axis
- ✓ Rotary encoder on A/C axis
- ✓ Rigid tapping
- ✓ Ethernet ,CF card and USB interface
- ✓ Centralized automatic grease lubrication system
- ✓ Coolant system
- ✓ Air blast during cutting
- ✓ LED working lamp
- ✓ End of program light
- ✓ Electronic handwheel (MPG)
- ✓ Tool box
- ✓ Leveling bolts and blocks
- ✓ Coolant gun
- ✓ Air gun
- ✓ User Manual

## Optional configuration

- Built-in spindle HSK A63 18000rpm(U500-5X)
- Built-in spindle HSK E50 36000rpm(U500-5X)
- CTS Coolant through spindle + ATS
- Oil cooling through ballscrew
- Workpiece probe
- Tool probe
- Dynamic Collision Monitoring (DCM)
- Kinematics
- Oil mist collector
- Minimum Quantity Lubrication system
- Coolant Cooling system
- Extra 200GB SSD program memory

\* The above specifications are subject to change without prior notice, no liability for mistakes. Machines may be shown with optional equipment.



## Cutting Area (U500-5X)

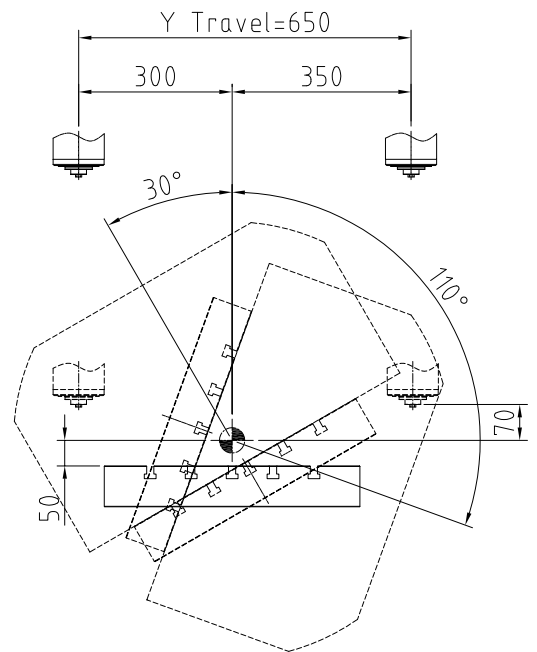
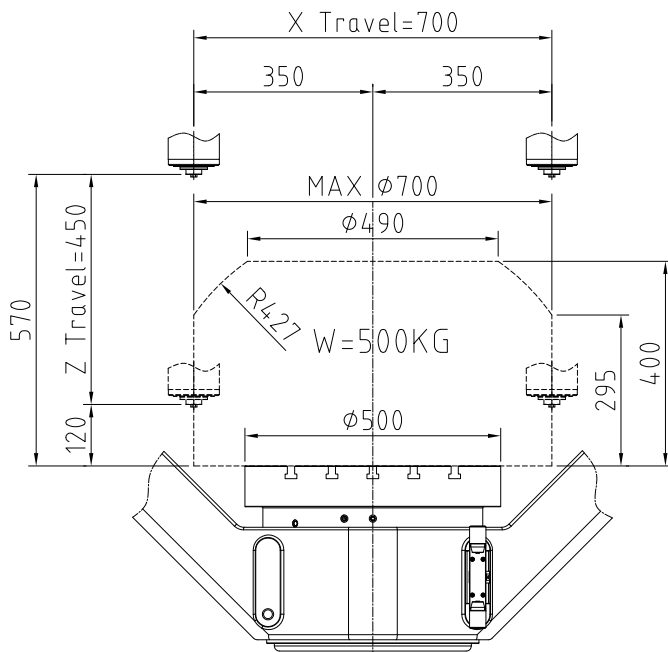

## Dimensions (U500-5X)

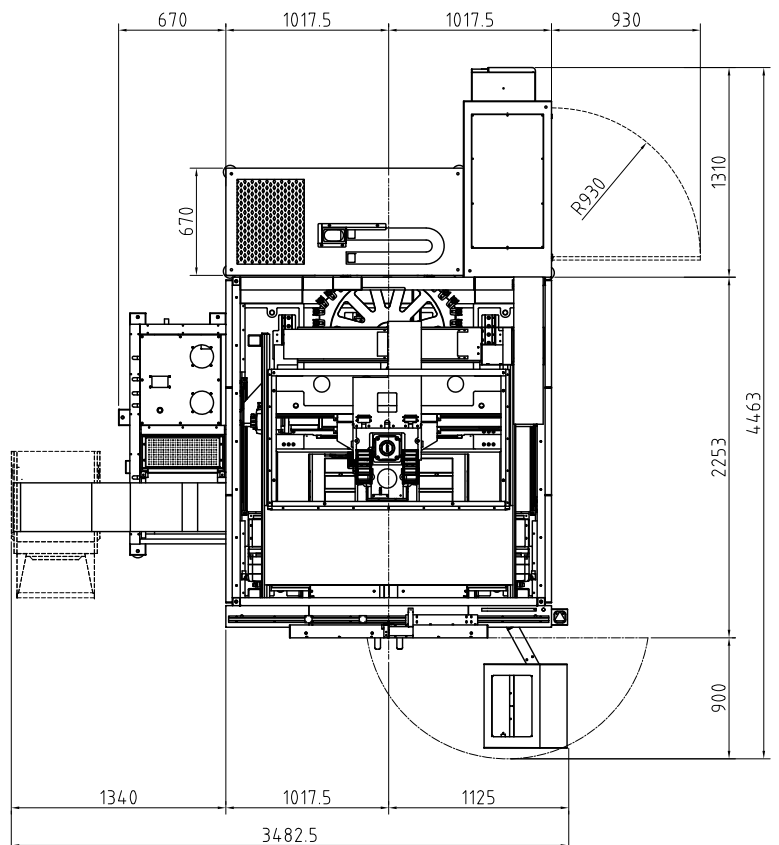
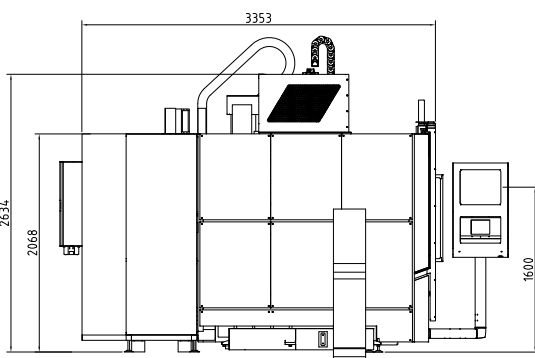
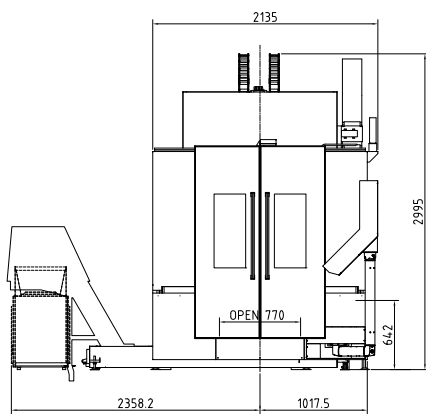

\* The above specifications are subject to change without prior notice, no liability for mistakes. Machines may be shown with optional equipment.

# C500-5X



- X/Y/Z axis movement are separated from the machining area
- Dual-support rotary table, high rigidity, high performance and efficiency
- A/C axis with roller gear cam drive
- X/Y/Z axis optional with direct measuring system
- A/C axis standard with rotary encoder

Technical Specifications		C500-5X
<b>Table</b>		
Max. workpiece diameter	mm	700
Table size	mm	Φ500 x 400
T-slot (width x number x distance)	mm	14 x 80 x 5
Max. load	kg	300
<b>Travel</b>		
X/Y/Z Travel	mm	700/550/500
A/C Travel	deg	+30° ~ -120°/360°
Spindle nose to table	mm	120 - 620
<b>Spindle</b>		
Spindle taper	-	HSK A63
Spindle motor power	kW	8.5/33.5
Spindle motor torque	Nm	63/135
Spindle speed	rpm	15000
<b>Feed</b>		
Rapid feed X/Y/Z	m/min	48
Rotation speed A/C	rpm	50/60
Cutting speed	mm/min	1-12000
<b>Tool changer</b>		
Number of tools	pcs	60
Max. tool length	mm	300
Max. tool diameter	mm	Φ80/Φ125
Max. tool weight	kg	8
<b>Accuracy(VDI 3441 Full travel)</b>		
Positioning accuracy (Without linear scales)	mm	0.008 (X/Y/Z) 10/8 arc-sec (A/C)
Repeatability accuracy (Without linear scales)	mm	0.006 (X/Y/Z) 8/6 arc-sec (A/C)
Positioning accuracy (With linear scales)	mm	0.006 (X/Y/Z) 10/8 arc-sec (A/C)
Repeatability accuracy (With linear scales)	mm	0.004 (X/Y/Z) 8/6 arc-sec (A/C)
<b>Dimensions &amp; Weight</b>		
Dimensions	mm	3976×4965×3050
Weight	kg	9500

## Standard configuration

- ✓ Roller gear cam drive rotary table
- ✓ Full enclosed splash guard
- ✓ Direct drive spindle 15000rpm
- ✓ 60 pockets chain type tool changer
- ✓ Chain type chip conveyor
- ✓ Spindle oil cooler
- ✓ Rotary encoder on A/C axis
- ✓ Air-conditioned electrical cabinet
- ✓ Rigid tapping
- ✓ Ethernet, CF card and USB interface
- ✓ Automatic lubrication system
- ✓ Coolant system
- ✓ Air blast during cutting
- ✓ LED working lamp
- ✓ End of program light
- ✓ Electrical handwheel (MGP)
- ✓ Tool box
- ✓ Leveling bolts and blocks
- ✓ Coolant gun
- ✓ Air gun
- ✓ User manual

## Optional configuration

- Built-in spindle 18000rpm HSK A63, 30/36kW\_85/102Nm
- Built-in spindle 20000rpm HSK A63, 20/24kW\_48/58Nm
- Linear scales on X/Y/Z axis
- CTS Coolant Through Spindle + ATS
- Workpiece probe
- Tool probe
- Oil mist collector
- Oil skimmer
- Dynamic Collision Monitoring (DCM)
- Kinematics
- Extra 200GB SSD program memory

\* The above specifications are subject to change without prior notice, no liability for mistakes. Machines may be shown with optional equipment.



## Cutting Area

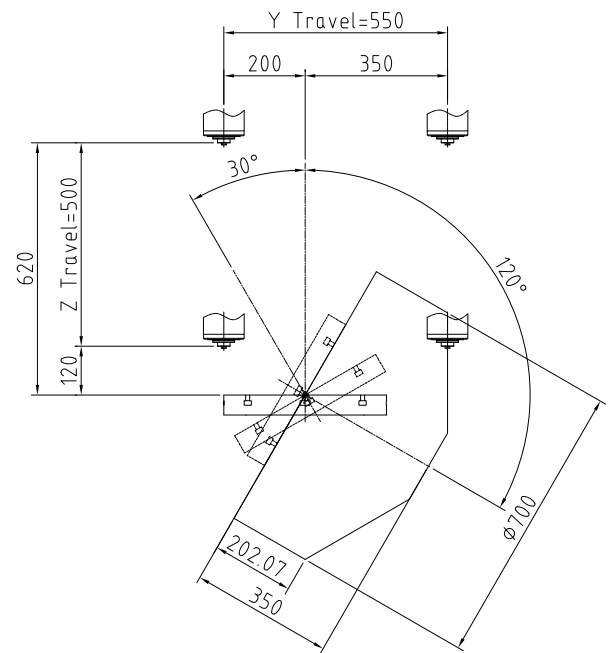
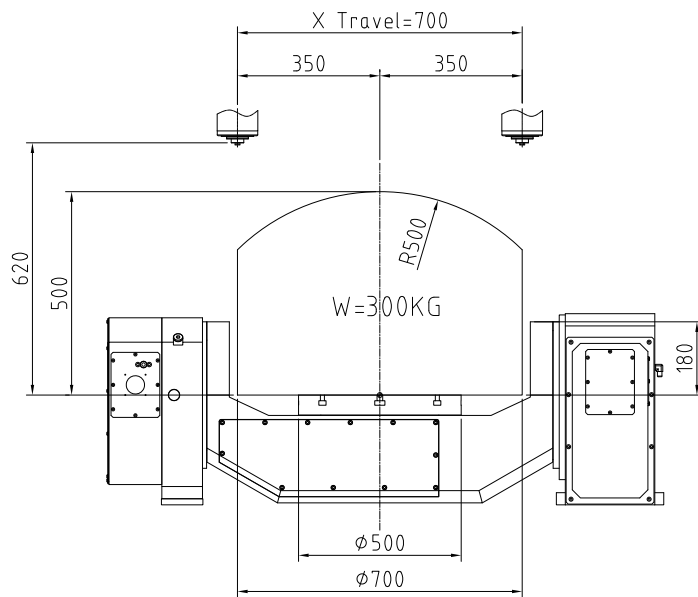

## Workpiece samples



\* The above specifications are subject to change without prior notice, no liability for mistakes. Machines may be shown with optional equipment.

# GT18-5X



Technical Specifications		GT18-5X
<b>Table</b>		
Table size	mm	1800 x 1400
T-slot (width x number x distance)	mm	22 x 7 x 170
Max. load	kg	6000
<b>Travel</b>		
X/Y/Z Travel	mm	1900/1400/800
Spindle nose to table	mm	100 - 900
90°spindle center line to table	mm	410-1210
Distance between columns	mm	1960
<b>B/C Head</b>		
B/C Travel	-	±108°/±270°
Clamping torque	Nm	2000/3000
<b>Spindle</b>		
Spindle taper	-	HSK A63
Motor power	kW	42/56.7
Motor torque	Nm	68/90.2
Spindle speed	rpm	24000
<b>Feed</b>		
Rapid feed X/Y/Z	m/min	24
Cutting speed	mm/min	1-12000
A(B)/C Max. speed	rpm	50
<b>Tool changer</b>		
Number of tools	pcs	60
Max. tool length	mm	300
Max. tool diameter	mm	Φ78/Φ150
Max. tool weight	kg	8
<b>Accuracy(VDI 3441 Full travel)</b>		
Positioning accuracy	mm	0.010/0.010/0.008 (X/Y/Z) 6/8 arc-sec (B/C)
Repeatability accuracy	mm	0.006 (X/Y/Z) 3/4 arc-sec (B/C)
<b>Dimensions &amp; Weight</b>		
Dimensions	mm	6160×4970×4840
Weight	kg	24000

## Standard configuration

- ✓ Direct drive B/C head
- ✓ Full enclosed splash guard
- ✓ Chip conveyor (two screw type and one chain type)
- ✓ Air-conditioned electrical cabinet
- ✓ High precision spindle water cooler
- ✓ Linear scales on X/Y/Z axis
- ✓ Rotary encoder on B/C axis
- ✓ Rigid tapping
- ✓ Ethernet, CF card and USB interface
- ✓ Automatic lubrication system
- ✓ Coolant system
- ✓ Air blast during cutting
- ✓ LED working lamp
- ✓ End of program light
- ✓ Electronic handwheel (MPG)
- ✓ Tool box
- ✓ Leveling bolts and blocks
- ✓ Coolant gun
- ✓ Air gun
- ✓ User Manual

## Optional configuration

- Built-in spindle HSK A100 15000 rpm  
\_40/50kW\_103/129Nm, 40/60 pockets tool changer
- CTS Coolant through spindle + ATS
- Oil cooling through ballscrew
- Oil skimmer
- Coolant Cooling system
- Workpiece probe
- Tool probe
- Dynamic Collision Monitoring (DCM)
- Kinematics
- Extra 200GB SSD program memory

\* The above specifications are subject to change without prior notice, no liability for mistakes. Machines may be shown with optional equipment.





- High speed and high precision machining, widely applied for big die & mold, electronics, defense, aerospace and medical industry
- Dual drive on Y axis to ensure the best dynamic performance
- Torque motor direct drive double arm B/C head
- Heidenhain linear scales on X, Y, Z axis

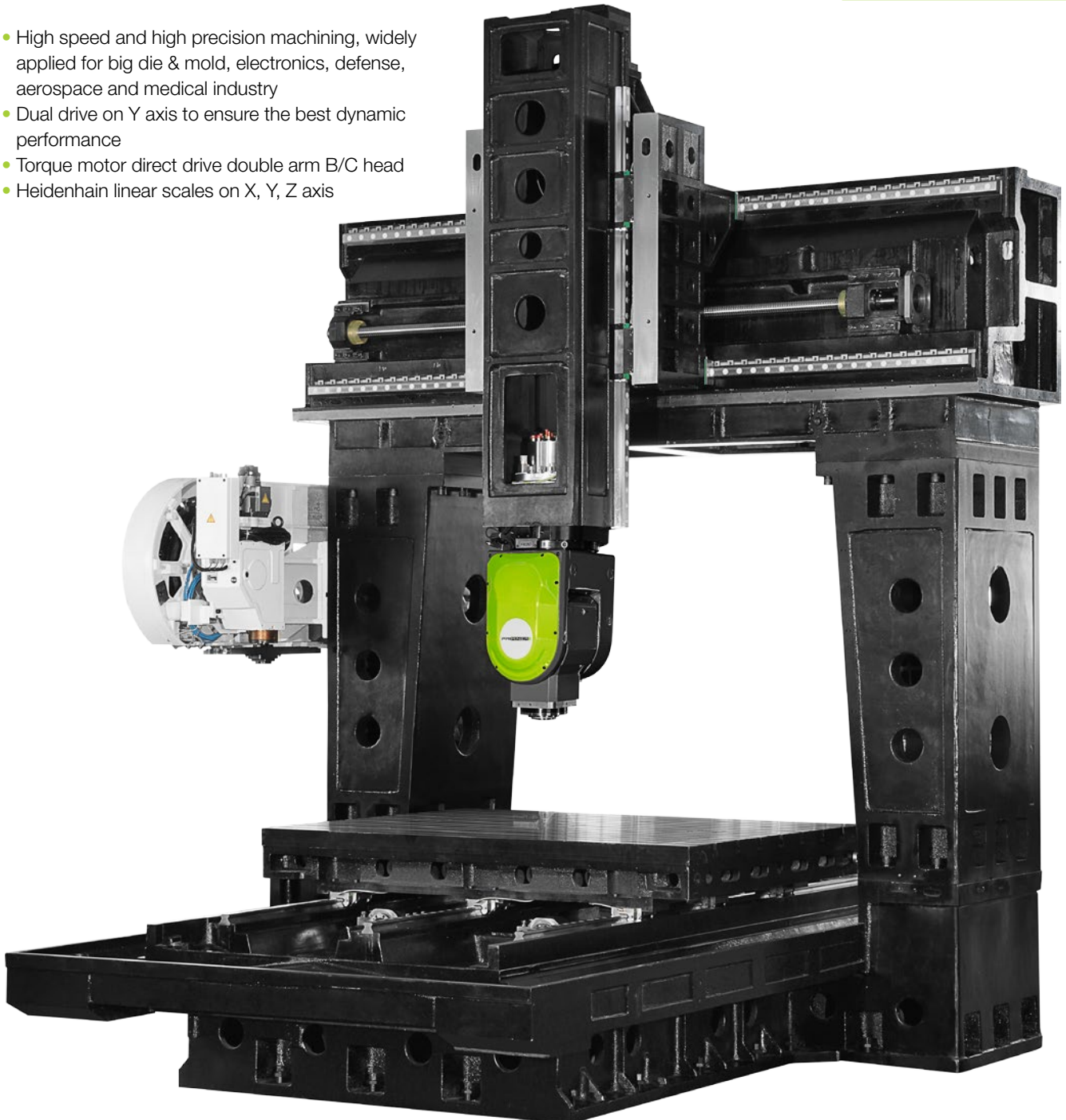

\* The above specifications are subject to change without prior notice, no liability for mistakes. Machines may be shown with optional equipment.

# GT320-5X · GT420-5X



Technical Specifications		GT320-5X	GT420-5X
Table			
Table size	mm	3300 ×1700	4000×1900
T-slot (width x number x distance)	mm	22 ×9×170	22×11×170
Max. load	kg	10000	12000
Travel			
X/Y/Z Travel	mm	3300/2700/1000	4200/2700/1000
Spindle nose to table	mm	155 - 1155	
90°spindle center line to table	mm	465-1465	
Distance between columns	mm	2000	
A/C Head			
A/C Travel	-	±108°/±270°	
A/C Clamping torque	Nm	2000/3000	
Spindle			
Spindle taper	-	HSK A63	
Motor power	kW	42/56.7	
Motor torque	Nm	68/90.2	
Spindle speed	rpm	24000	
Feed			
Rapid feed X/Y/Z	m/min	20	15/20/20
Cutting speed	mm/min	1-12000	
A/C Max. speed	rpm	50	
Tool changer			
Number of tools	pcs	60	
Max. tool length	mm	300	
Max. tool diameter	mm	Φ80/Φ125	
Max. tool weight	kg	8	
Accuracy(VDI 3441 Full travel)			
Positioning accuracy	mm	0.015/0.015/0.010 (X/Y/Z) 6/8 arc-sec (A/C)	0.020/0.015/0.010 (X/Y/Z) 6/8 arc-sec (A/C)
Repeatability accuracy	mm	0.010/0.010/0.006 (X/Y/Z) 3/4 arc-sec (A/C)	0.015/0.010/0.006 (X/Y/Z) 3/4 arc-sec (A/C)
Dimensions & Weight			
Dimensions	mm	9672×6300×5570	11692×6300×5560
Weight	ka	30000	42000

## Standard configuration

- ✓ Direct drive A/C head
- ✓ Full enclosed splash guard
- ✓ Chip conveyor (two screw type and one chain type)
- ✓ Air-conditioned electrical cabinet
- ✓ High precision spindle water cooler
- ✓ Linear scales on X/Y/Z axis
- ✓ Rotary encoder on A/C axis
- ✓ Rigid tapping
- ✓ Ethernet, CF card and USB interface
- ✓ Automatic lubrication system
- ✓ Coolant system
- ✓ Air blast during cutting
- ✓ LED working lamp
- ✓ End of program light
- ✓ Electronic handwheel (MPG)
- ✓ Tool box
- ✓ Leveling bolts and blocks
- ✓ Coolant gun
- ✓ Air gun
- ✓ User Manual

## Optional configuration

- Built-in spindle HSK A100 15000 rpm  
\_40/50kW\_103/129Nm, 40/60 pockets tool changer
- CTS Coolant through spindle + ATS
- Oil skimmer
- Workpiece probe
- Tool probe
- Dynamic Collision Monitoring (DCM)
- Kinematics
- Extra 200GB SSD program memory

\* The above specifications are subject to change without prior notice, no liability for mistakes. Machines may be shown with optional equipment.





- High speed and high precision machining, widely applied for big die & mold, electronics, defense, aerospace and medical industry
- Torque motor direct drive double arm A/C head
- Heidenhain linear scales on X, Y, Z axis

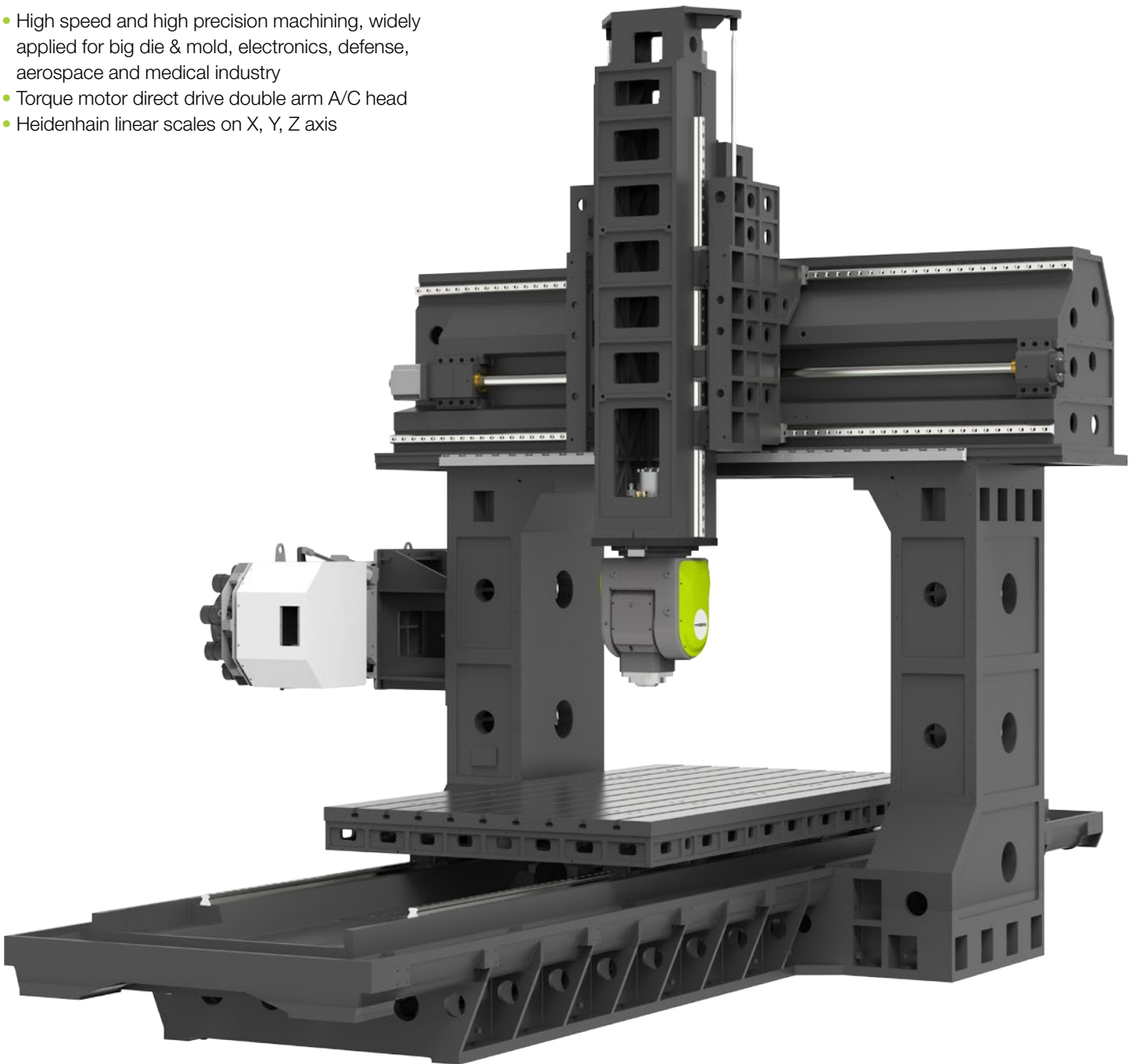

\* The above specifications are subject to change without prior notice, no liability for mistakes. Machines may be shown with optional equipment.

# GT428-5X



Technical Specifications		GT428-5X		
Table				
Table size	mm	4000×2400		
T-slot (width x number x distance)	mm	28×11×200		
Max. load	kg	15000		
Travel				
X/Y/Z Travel	mm	4200/3300/1200		
Spindle nose to table	mm	80 - 1280	-40 - 1160	85-1285
90°spindle center line to table	mm	363-1563	310-1510	452.5-1652.5
Distance between columns	mm	2800		
A/C Head		Model L	Model XL	Model S
A/C Travel	-	±115°/360°	±110°/±250°	±108°/±270°
A/C Clamping torque	Nm	10500/5400	8000/8000	2000/3000
Spindle				
Spindle taper	-	HSK A100	HSK A100	HSK A100
Motor power	kW	50/61	40/47	40/50
Motor torque	Nm	160/193	248/293	103/129
Spindle speed	rpm	15000	12000	15000
Feed				
Rapid feed X/Y/Z	m/min	12/15/20		
Cutting speed	mm/min	1-12000		
A(B)/C Max. speed	rpm	50		
Tool changer				
Number of tools	pcs	60		
Max. tool length	mm	400		
Max. tool diameter	mm	Φ125/Φ250		
Max. tool weight	kg	16		
Accuracy(VDI 3441 Full travel)				
Positioning accuracy	mm	0.020/0.015/0.010 (X/Y/Z) 6/8 arc-sec (A/C)		
Repeatability accuracy	mm	0.015/0.010/0.006 (X/Y/Z) 3/4 arc-sec (A/C)		
Dimensions & Weight				
Dimensions	mm	11980×6751×6320		
Weight	kg	52000		

## Standard configuration

- ✓ Direct drive A/C head
- ✓ Full enclosed splash guard
- ✓ Model L AC head,built-in spindle HSK A100 15000 rpm
- ✓ 60 pockets chain type tool changer
- ✓ Chip conveyor (two screw type and one chain type)
- ✓ Air-conditioned electrical cabinet
- ✓ High precision spindle water cooler
- ✓ Linear scales on X/Y/Z axis
- ✓ Rotary encoder on A/C axis
- ✓ Rigid tapping
- ✓ Ethernet, CF card and USB interface
- ✓ Automatic lubrication system
- ✓ Coolant system
- ✓ Air blast during cutting
- ✓ LED working lamp
- ✓ End of program light
- ✓ Electronic handwheel (MPG)
- ✓ Tool box
- ✓ Leveling bolts and blocks
- ✓ Coolant gun
- ✓ Air gun
- ✓ User Manual

## Optional configuration

- Model XL AC head,built-in spindle HSK A100 12000 rpm
- Model S AC head,built-in spindle HSK A100 15000 rpm
- CTS Coolant through spindle + ATS
- Oil skimmer
- Workpiece probe
- Tool probe
- Dynamic Collision Monitoring (DCM)
- Kinematics
- Extra 200GB SSD program memory





- Torque motor direct drive double arm head
- Heidenhain linear scales on X, Y, Z axis
- 4 linear guideways on Z axis ensure high rigidity and high accuracy
- Z axis designed with dual drive technology two ballscrews for high dynamic machining
- 3 linear guideways on Y axis
- Extra wide machine column and base design ensures the high rigidity for heavy duty cutting

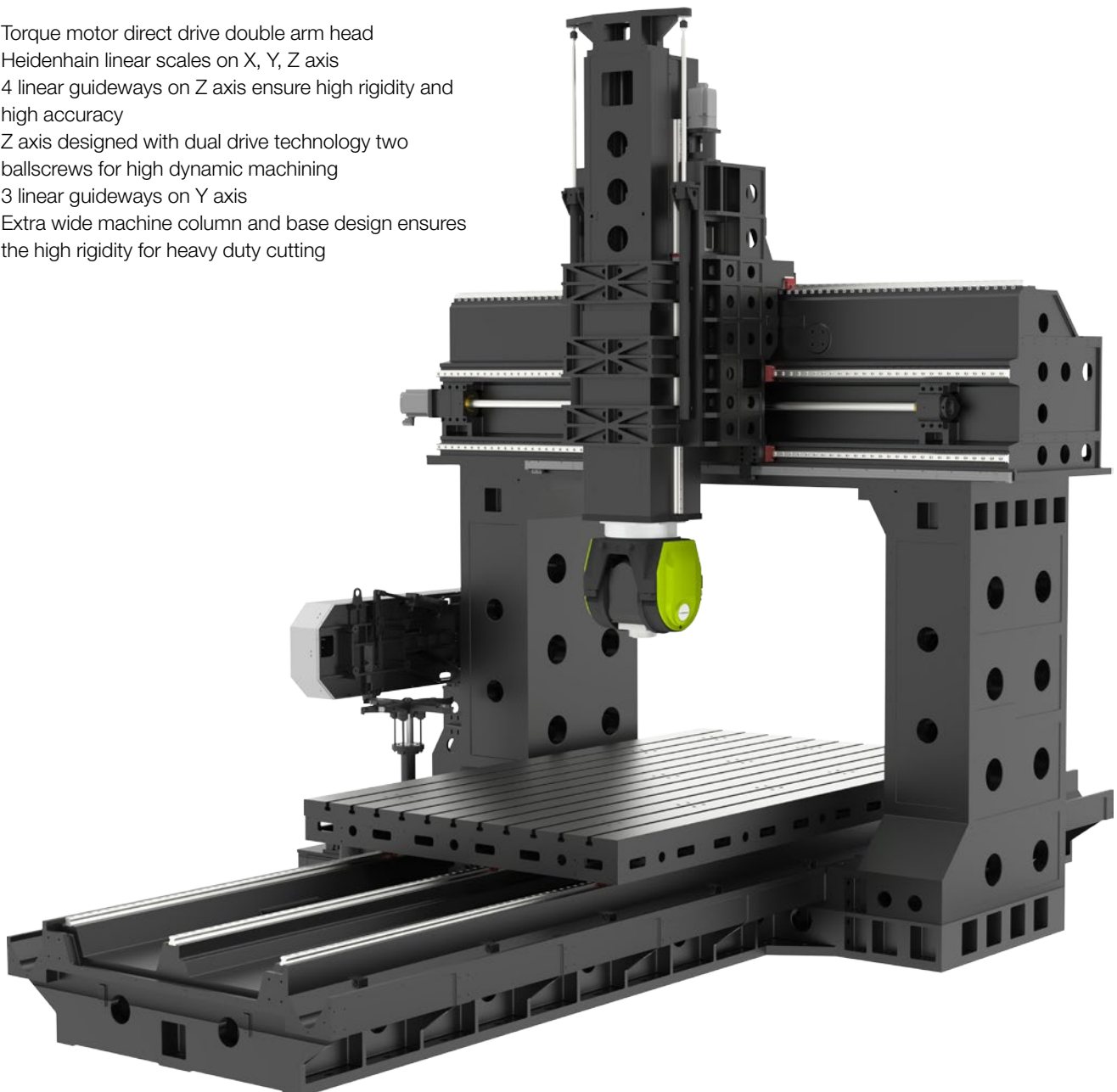

\* The above specifications are subject to change without prior notice, no liability for mistakes. Machines may be shown with optional equipment.

# GT428-5XG



Technical Specifications		GT428-5XG
<b>Table</b>		
Table size	mm	4000×2400
T-slot (width x number x distance)	mm	28×11×200
Max. load	kg	15000
<b>Travel</b>		
X/Y/Z Travel	mm	4200/3300/1200
Spindle nose to table	mm	250-1450
90°spindle center line to table	mm	475-1675
Distance between columns	mm	2800
<b>A/C Head</b>		
A/C Travel	-	±135°/±180°
A/C Clamping torque	kg	10000
<b>Spindle</b>		
Spindle taper	-	BT50
Motor power	kW	30/62
Motor torque	Nm	1028/1776
Spindle speed	rpm	3000/4000 (S1/S6)
<b>Feed</b>		
Rapid feed X/Y/Z	m/min	12/15/20
Cutting speed	mm/min	1-12000
<b>Tool changer</b>		
Number of tools	pcs	60
Max. tool length	mm	400
Max. tool diameter	mm	Φ125/Φ250
Max. tool weight	kg	16
<b>Accuracy(VDI 3441 Full travel)</b>		
Positioning accuracy	mm	0.020/0.015/0.010 (X/Y/Z)
Repeatability accuracy	mm	0.015/0.010/0.006 (X/Y/Z)
<b>Dimensions &amp; Weight</b>		
Dimensions	mm	11980×6751×6320
Weight	kg	52000

## Standard configuration

- ✓ Siemens 828D Control PPU290 (3+2)
- ✓ Orthogonal Auto-Indexing Milling Head
- ✓ Full enclosed splash guard
- ✓ Chip conveyor (two screw type and one chain type)
- ✓ BT50 chain type tool changer 60 pockets
- ✓ Spindle motor with high precision water cooler
- ✓ Spindle and gearbox oil cooler
- ✓ Air-conditioned electrical cabinet
- ✓ Linear scales on X/Y/Z axis
- ✓ Rigid tapping
- ✓ Ethernet, CF card and USB interface
- ✓ Automatic lubrication system
- ✓ Coolant system
- ✓ Air blast during cutting
- ✓ LED working lamp
- ✓ End of program light
- ✓ Electronic handwheel (MPG)
- ✓ Tool box
- ✓ Leveling bolts and blocks
- ✓ Coolant gun
- ✓ Air gun
- ✓ User Manual

## Optional configuration

- CTS Coolant through spindle + ATS
- Oil skimmer
- Workpiece probe
- Tool probe
- Extra 200GB SSD program memory

\* The above specifications are subject to change without prior notice, no liability for mistakes. Machines may be shown with optional equipment.



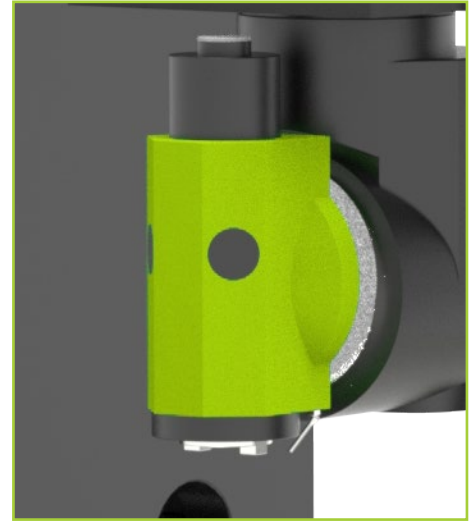

- Orthogonal Auto-Indexing Milling Head with 2.5° indexing
- Heidenhain linear scales on X, Y, Z axis
- 4 linear guideways on Z axis ensure high rigidity and high accuracy
- Z axis designed with dual drive technology two ballscrews for high dynamic machining
- 3 linear guideways on Y axis
- Extra wide machine column and base design ensures the high rigidity for heavy duty cutting

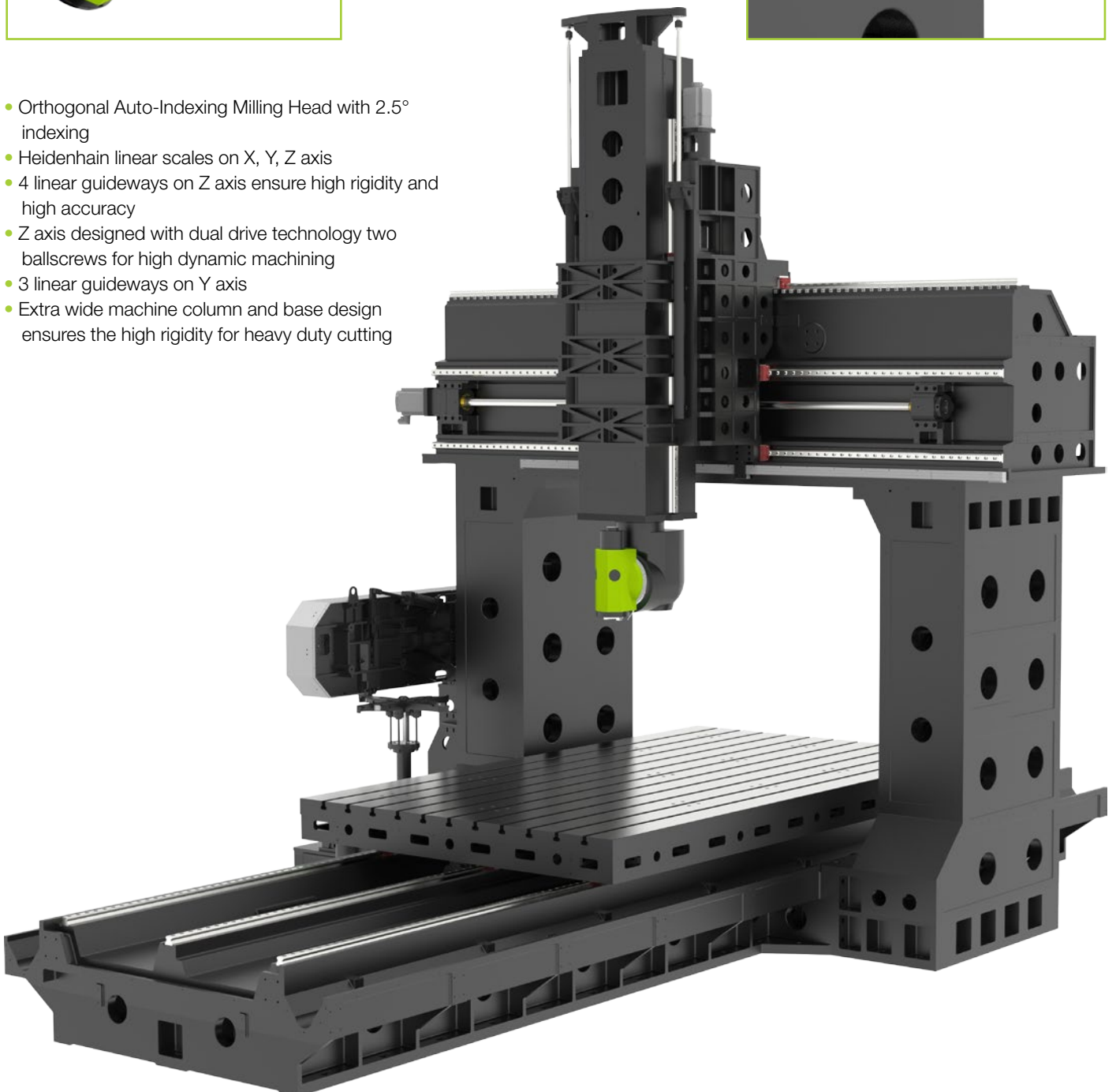

\* The above specifications are subject to change without prior notice, no liability for mistakes. Machines may be shown with optional equipment.

## GT7

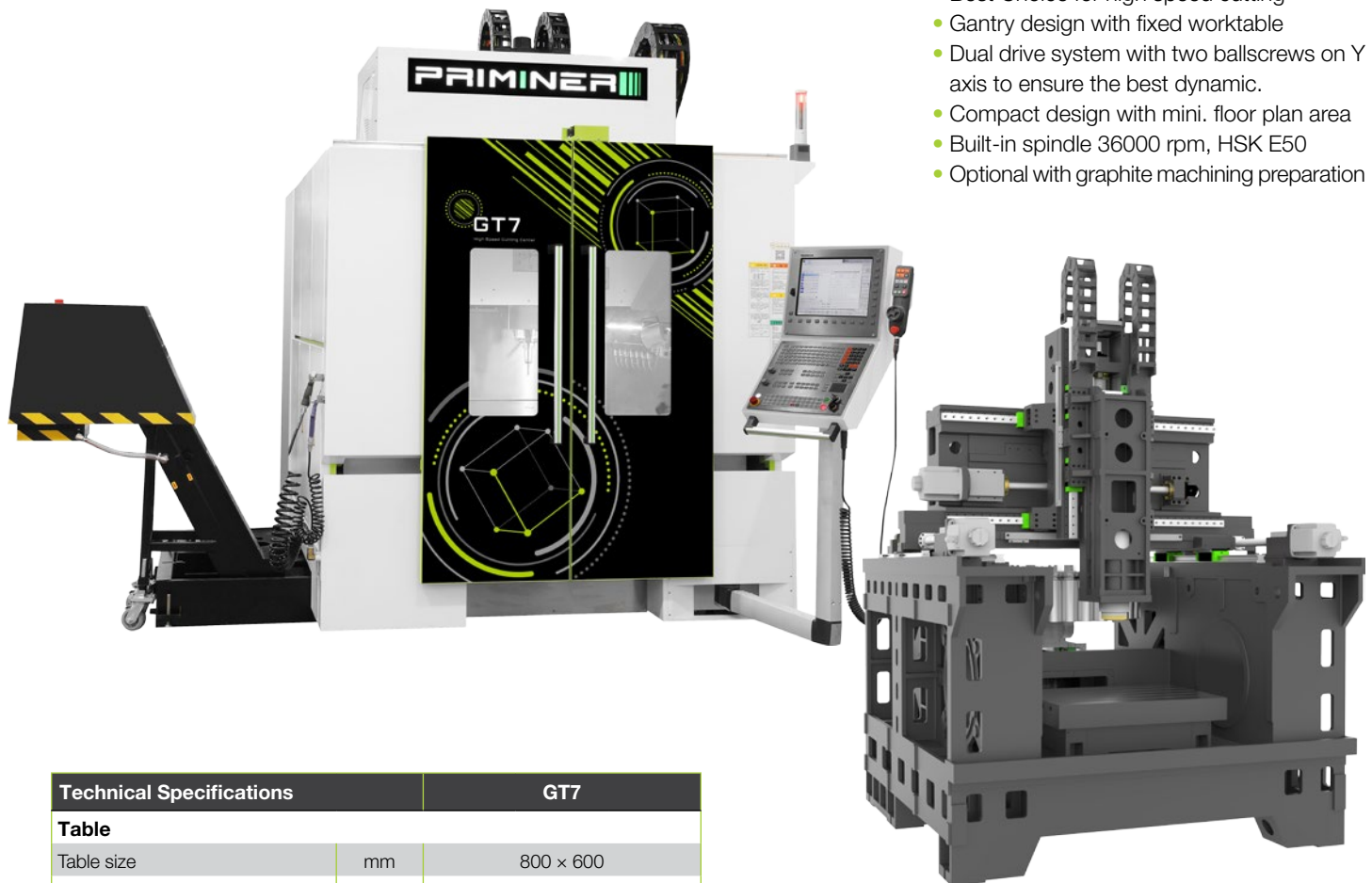

- Best Choice for high speed cutting
- Gantry design with fixed worktable
- Dual drive system with two ballscrews on Y axis to ensure the best dynamic.
- Compact design with mini. floor plan area
- Built-in spindle 36000 rpm, HSK E50
- Optional with graphite machining preparation

Technical Specifications		GT7		
Table				
Table size	mm	800 × 600		
T-slot (width x number x distance)	mm	18 × 5 × 100		
Max. load	kg	600		
Travel				
X/Y/Z Travel	mm	700/600/450		
Spindle				
Spindle taper	-	HSK A63	HSK E50	HSK E32
Spindle motor power	kW	20/24	15/18	6.3/9.45
Spindle motor torque	Nm	48/58	14/17.3	2/3
Spindle speed	rpm	20000	36000	40000
Spindle nose to table	mm	135-585	135-585	145-595
Feed				
Rapid feed X/Y/Z	m/min	15		
Cutting speed	mm/min	1-12000		
Tool changer				
Number of tools	pcs	32		
Max. tool length	mm	250		
Max. tool diameter	mm	63		
Max. tool weight	kg	4		
Accuracy (VDI 3441 Full travel)				
Positioning accuracy	mm	0.006		
Repeatability accuracy	mm	0.003		
Dimensions & Weight				
Dimensions	mm	3560×3380×2995		
Weight	kg	8000		

### Standard configuration

- ✓ Full enclosed splash guard
- ✓ Built-in motor spindle HSK E50 36000 rpm
- ✓ 32 pockets tool changer
- ✓ Chain type chip conveyor
- ✓ Air-conditioned electrical cabinet
- ✓ High precision spindle water cooler
- ✓ Linear scales on X/Y/Z axis
- ✓ Rigid tapping
- ✓ Ethernet, CF card and USB interface
- ✓ Centralized automatic grease lubrication system
- ✓ Coolant system
- ✓ Air blast during cutting
- ✓ LED working lamp
- ✓ End of program light
- ✓ Electronic handwheel (MPG)
- ✓ Tool box
- ✓ Leveling bolts and blocks
- ✓ Coolant gun
- ✓ Air gun
- ✓ User Manual

### Optional configuration

- Built-in spindle HSK A63 20000rpm, 32 pockets tool changer
- Built-in spindle HSK E32 40000rpm, 48 pockets tool changer
- Graphite Machining Preparation
- Oil mist collector
- Oil cooling through ballscrew
- CTS Coolant through spindle + ATS
- Oil skimmer
- Minimum Quantity Lubrication system
- Coolant Cooling system
- Workpiece probe
- Tool probe
- Extra 200GB SSD program memory

\* The above specifications are subject to change without prior notice, no liability for mistakes. Machines may be shown with optional equipment.



## Worktable

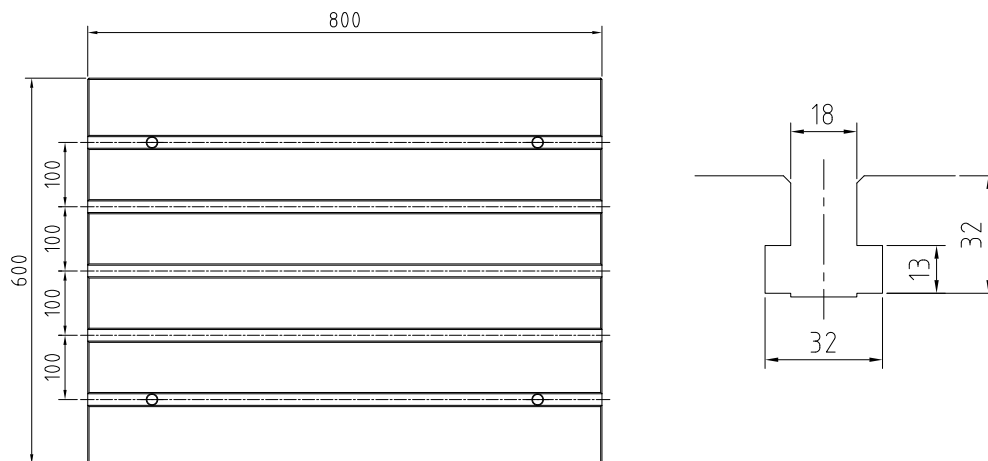

## Dimensions

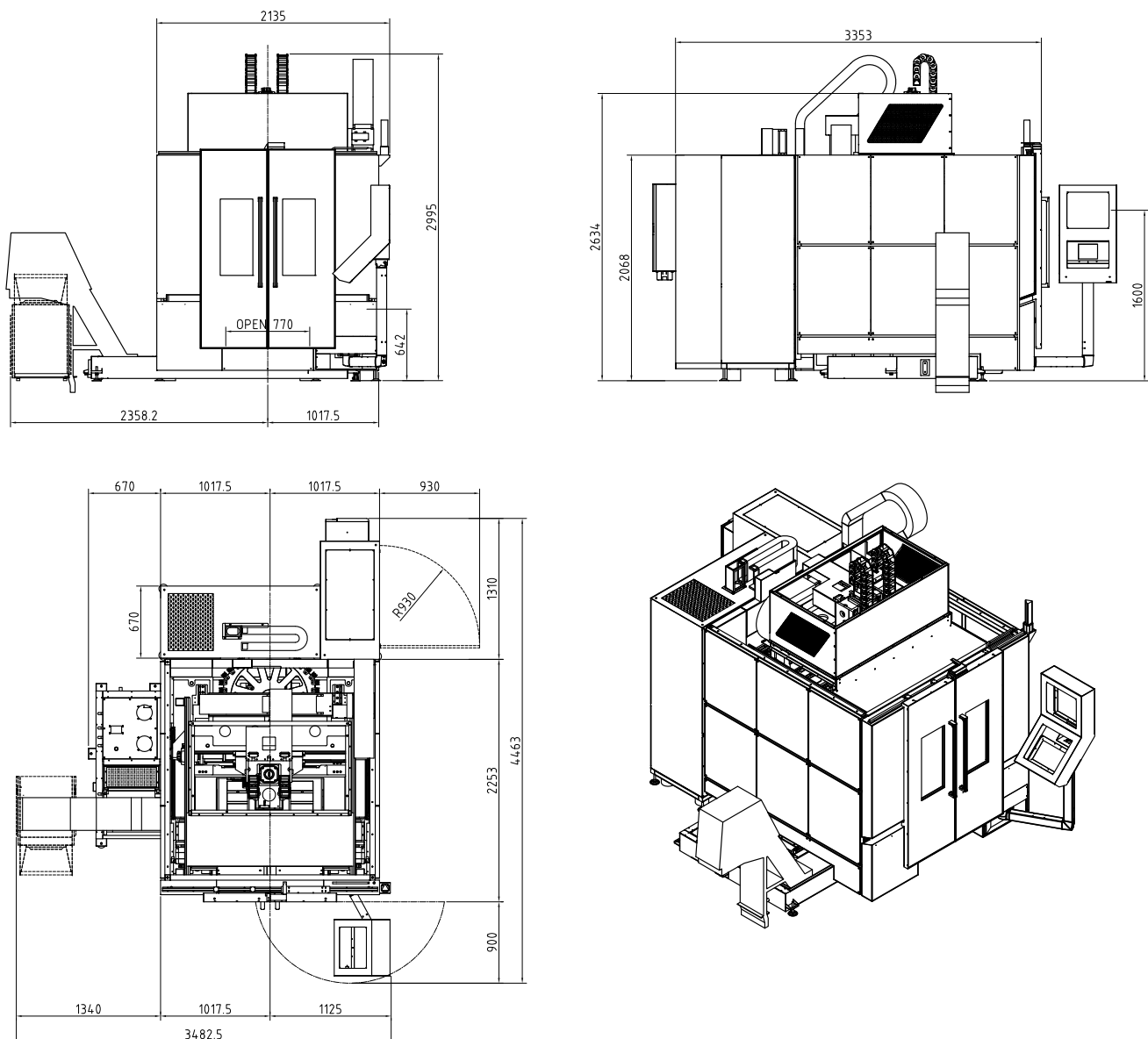

\* The above specifications are subject to change without prior notice, no liability for mistakes. Machines may be shown with optional equipment.

# GT11



Technical Specifications		GT11
<b>Table</b>		
Table size	mm	1200×700
T-slot (width x number x distance)	mm	18×6×100
Max. load	kg	1500
<b>Travel</b>		
X/Y/Z Travel	mm	1150 /700/520
Spindle nose to table	mm	140-660
<b>Spindle</b>		
Spindle taper		HSK A63
Motor power	kW	30/36
Motor torque	Nm	85/102
Spindle speed	rpm	18000
<b>Feed</b>		
Rapid feed X/Y/Z	m/min	24
Cutting speed	mm/min	1-12000
<b>Tool changer</b>		
Number of tools	pcs	40
Max. tool length	mm	300
Max. tool diameter	mm	Φ78/Φ125
Max. tool weight	kg	8
<b>Accuracy (VDI3441 Full travel)</b>		
Positioning accuracy	mm	0.006
Repeatability accuracy	mm	0.003
<b>Dimensions &amp; Weight</b>		
Dimensions	mm	3680×3180×3090
Weight	kg	9000

\* The above specifications are subject to change without prior notice, no liability for mistakes. Machines may be shown with optional equipment.



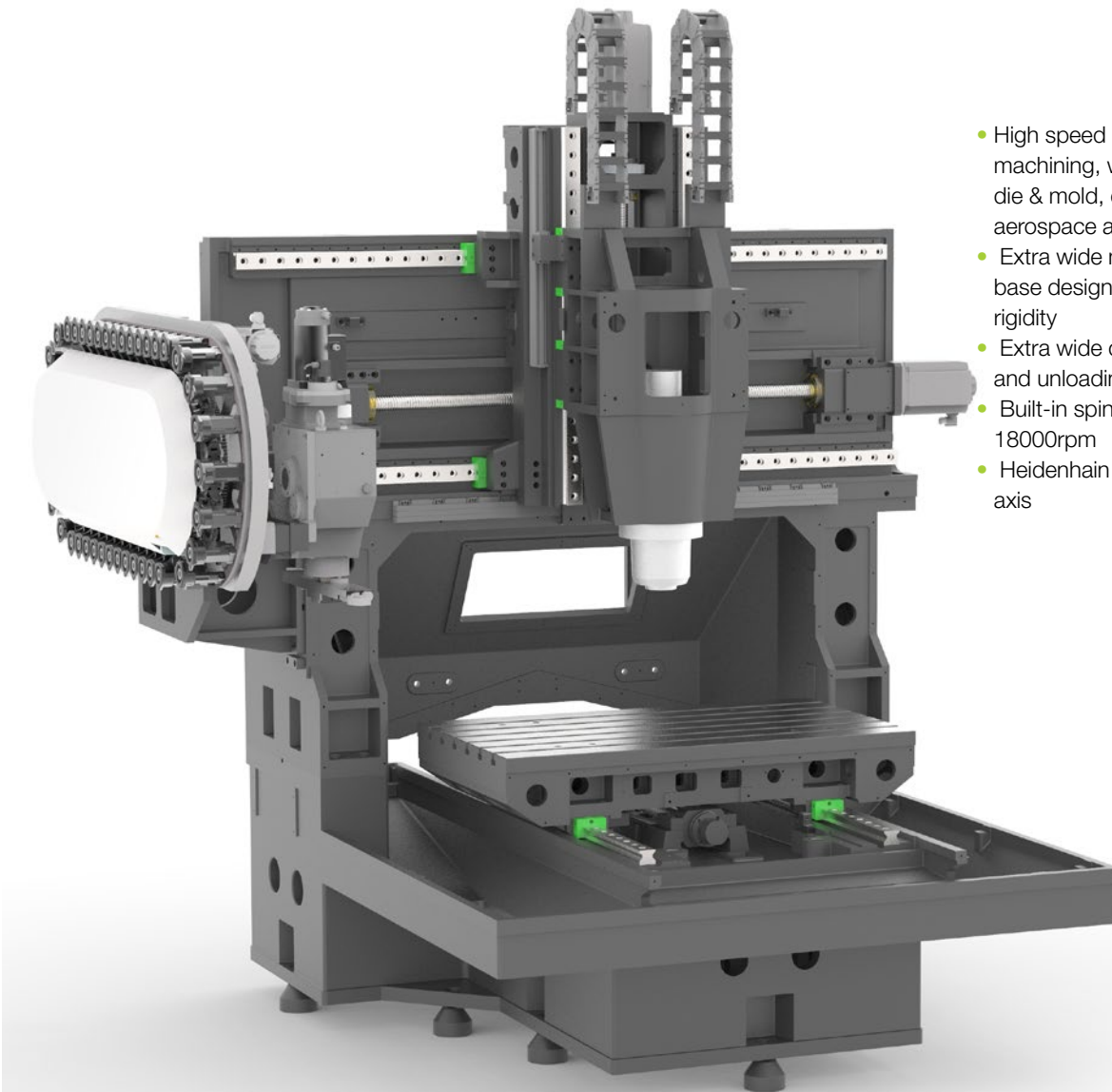

- High speed and high precision machining, widely applied for big die & mold, electronics, defense, aerospace and medical industry
- Extra wide machine column and base design ensures the high rigidity
- Extra wide door for easy loading and unloading
- Built-in spindle HSK A63 18000rpm
- Heidenhain linear scales on X/Y/Z axis



## Standard configuration

- ✓ Full enclosed splash guard
- ✓ Built-in spindle HSK A63 18000 rpm
- ✓ 40 pockets chain type tool changer
- ✓ Two screw type and one chain type chip conveyor
- ✓ Air-conditioned electrical cabinet
- ✓ High precision spindle water cooler
- ✓ Linear scales on X/Y/Z
- ✓ Rigid tapping
- ✓ Ethernet, CF card and USB interface
- ✓ Automatic lubrication system
- ✓ Coolant system
- ✓ Air blast during cutting
- ✓ LED working lamp
- ✓ End of program light
- ✓ Electronic handwheel (MPG)
- ✓ Tool box
- ✓ Leveling bolts and blocks
- ✓ Coolant gun
- ✓ Air gun
- ✓ User Manual

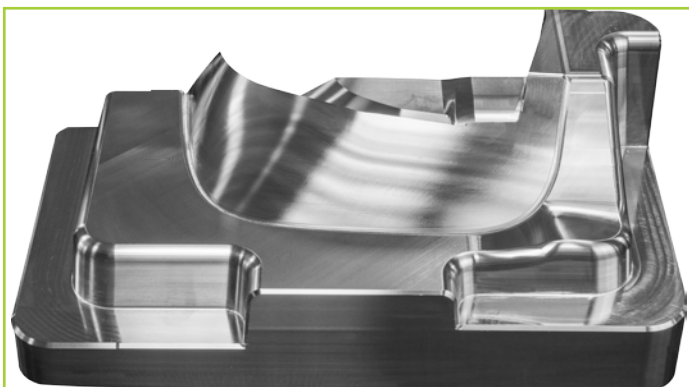

## Optional configuration

- Built-in spindle HSK A63 16000rpm, 30/36 kW, 100/120 Nm
- CTS Coolant through spindle + ATS
- Oil cooling through ballscrew
- Oil skimmer
- Oil mist collector
- Workpiece probe
- Tool probe
- Extra 200GB SSD program memory

\* The above specifications are subject to change without prior notice, no liability for mistakes. Machines may be shown with optional equipment.

# GT18



Technical Specifications		GT18
<b>Table</b>		
Table size	mm	1800×1400
T-slot (width x number x distance)	mm	22×7×170
Max. load	kg	6000
<b>Travel</b>		
X/Y/Z Travel	mm	1800/1400/800
Spindle nose to table	mm	150-950
Spindle center to column	mm	400
Distance between columns	mm	1960
<b>Spindle</b>		
Spindle taper		HSK A63
Motor power	kW	30/36
Motor torque	Nm	85/102
Spindle speed	rpm	24000
<b>Feed</b>		
Rapid feed X/Y/Z	m/min	24
Cutting speed	mm/min	1-12000
<b>Tool changer</b>		
Number of tools	pcs	60
Max. tool length	mm	300
Max. tool diameter	mm	Φ78/Φ150
Max. tool weight	kg	8
<b>Accuracy (VDI3441 Full travel)</b>		
Positioning accuracy	mm	0.010/0.010/0.008 (X/Y/Z)
Repeatability accuracy	mm	0.006 (X/Y/Z)
<b>Dimensions &amp; Weight</b>		
Dimensions	mm	6160×4970×4380
Weight	kg	22000

\* The above specifications are subject to change without prior notice, no liability for mistakes. Machines may be shown with optional equipment.



- High speed and high precision machining, widely applied for big die & mold, electronics, defense, aerospace and medical industry
- Extra wide machine column and base design ensures the high rigidity
- Dual drive system with two ballscrews and three linear guideways on Y axis to ensure high accuracy of machining
- Extra wide door for easy loading and unloading
- Built-in spindle HSK A63 24000rpm
- Heidenhain linear scales on three axes
- 60 pockets chain type servo tool changer

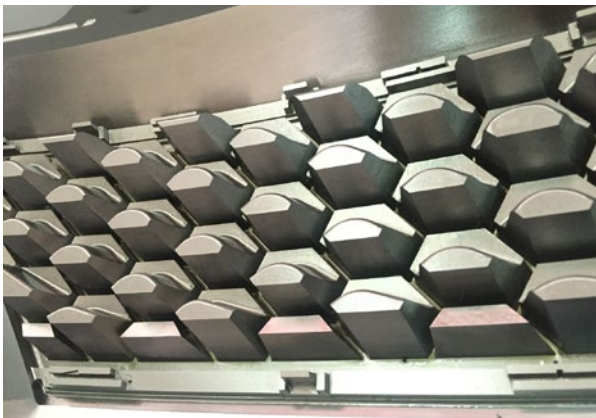
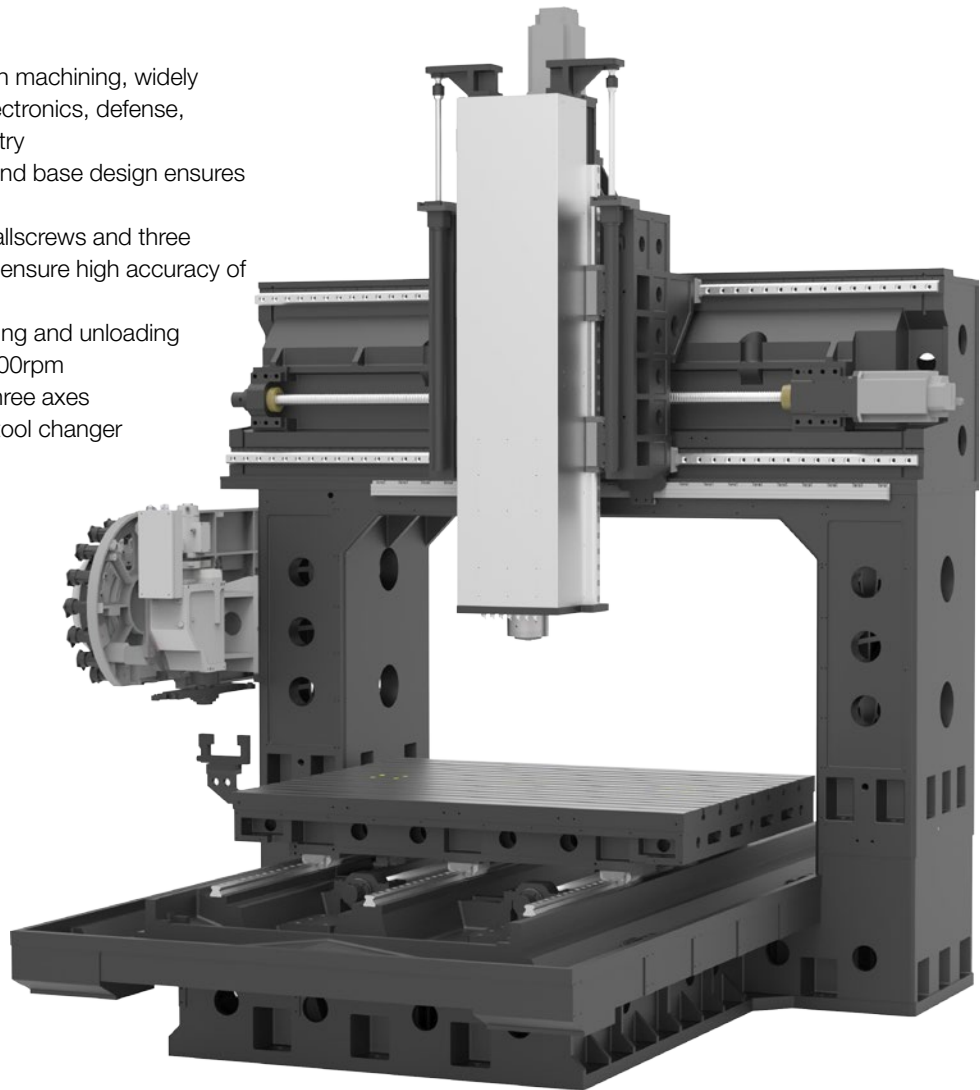

## Standard configuration

- ✓ Full enclosed splash guard
- ✓ Built-in spindle HSK A63 24000 rpm
- ✓ 60 pockets chain type servo tool changer
- ✓ Two screw type and one chain type chip conveyor
- ✓ Air-conditioned electrical cabinet
- ✓ High precision spindle water cooler
- ✓ Linear scales on X/Y/Z
- ✓ Oil-air lubrication system for spindle
- ✓ Rigid tapping
- ✓ Ethernet, CF card and USB interface
- ✓ Automatic lubrication system
- ✓ Coolant system
- ✓ Air blast during cutting
- ✓ LED working lamp
- ✓ End of program light
- ✓ Electronic handwheel (MPG)
- ✓ Tool box
- ✓ Leveling bolts and blocks
- ✓ Coolant gun
- ✓ Air gun
- ✓ User Manual

## Optional configuration

- CTS Coolant through spindle + ATS
- Oil cooling through ballscrew
- Oil skimmer
- Oil mist collector
- Workpiece probe
- Tool probe
- Extra 200GB SSD program memory

\* The above specifications are subject to change without prior notice, no liability for mistakes. Machines may be shown with optional equipment.

# UHP Center VF900 · 1100 · 1300 · 1500



- VF series ultra high performance center is specially designed for high speed and high efficiency machining applications
- Advanced design with reinforced body structure through FEM analysis. VF series offers superb cutting performance and reduced vibration to meet the highest machining demands
- Extra wide machine column and base design ensures the high rigidity during high speed movement
- Motor seat cooling circuit (VF1100, VF1300, VF1500)
- Linear scales (optional)

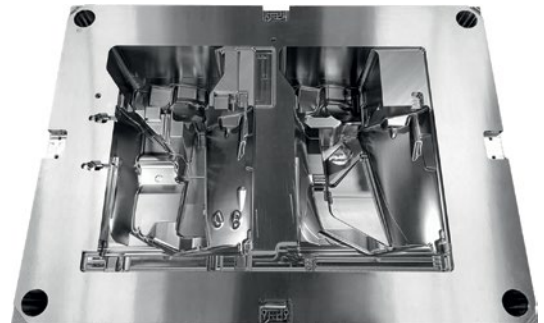

## Standard configuration

- ✓ Fully enclosed splash guard
- ✓ 24 pockets arm tool changer
- ✓ Two screw type and one chain type chip conveyor (VF 1100, VF1300)
- ✓ Chain type chip conveyor (VF900, VF1500)
- ✓ Spindle oil cooler
- ✓ Air-conditioned electrical cabinet
- ✓ Motor seat cooling circuit (VF1100, VF1300, VF1500)
- ✓ Rigid tapping
- ✓ Ethernet, CF card and USB interface
- ✓ Automatic lubrication system
- ✓ Coolant system
- ✓ LED working lamp
- ✓ End of program light
- ✓ Electronic handwheel (MPG)
- ✓ Tool box
- ✓ Leveling bolts and blocks
- ✓ Coolant gun
- ✓ Air gun
- ✓ Air blast during cutting
- ✓ User Manual

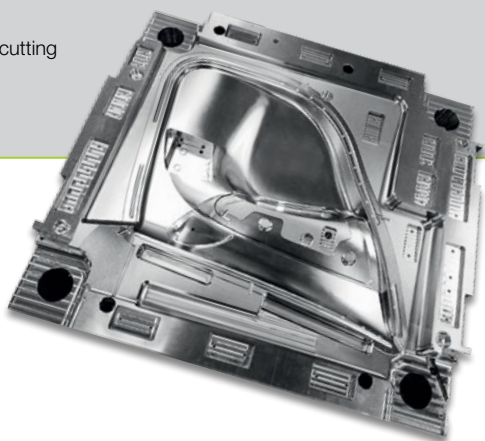

## Optional configuration

- 28 pockets arm tool changer
- 40 pockets chain type tool changer (VF1100, VF1300, VF1500)
- CTS coolant through spindle + ATS
- Oil cooling through ballscrew (VF1100, VF1300, VF1500)
- Oil skimmer
- Linear scales on X/Y/Z axis
- 4<sup>th</sup> axis
- 4/5<sup>th</sup> axis
- Workpiece probe
- Tool probe
- Extra 200GB SSD program memory (Only available on SIEMENS Control)

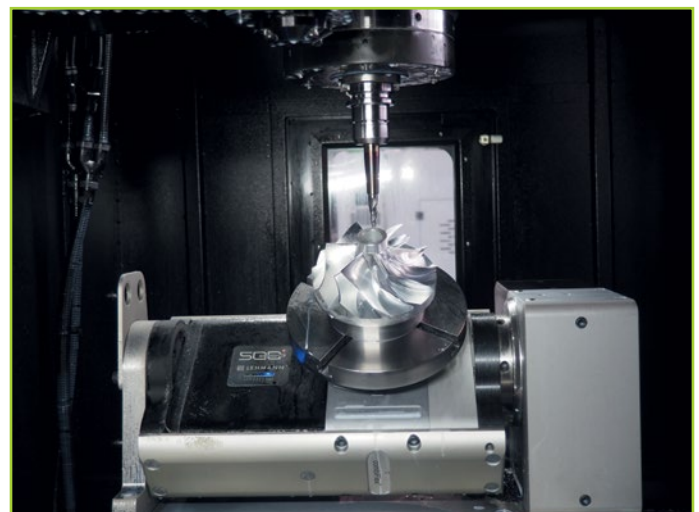

Lehmann 4<sup>th</sup> & 5<sup>th</sup> axis





Cast iron tempered for stress relief to ensure structural stability without deformation

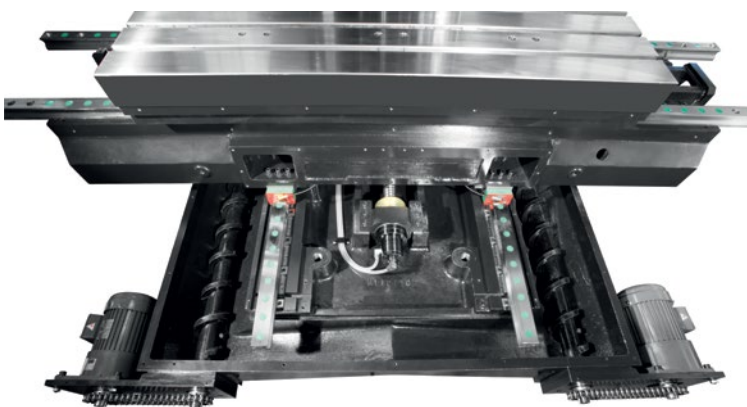

Two screw type chip conveyors in Y-axis (VF1100 , VF1300)



External tool cooling



High rigidity spindle

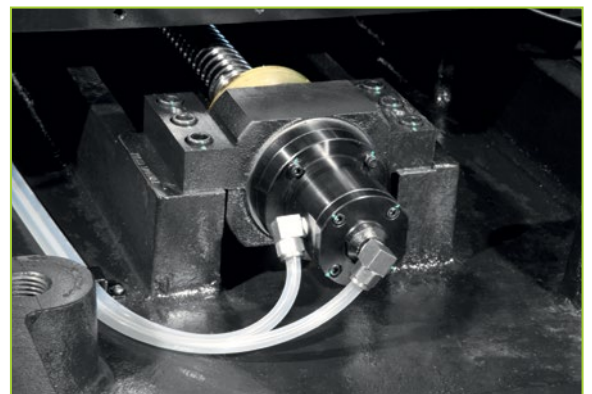

Oil cooling through ballscrew (optional for VF1100, VF1300, VF1500)

\* The above specifications are subject to change without prior notice, no liability for mistakes. Machines may be shown with optional equipment.

## Worktable (VF1100)

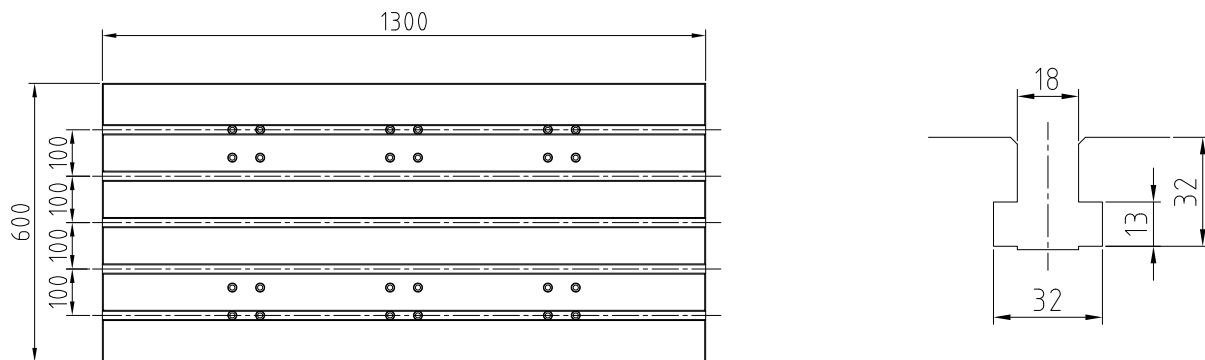

## Dimensions (VF1100)

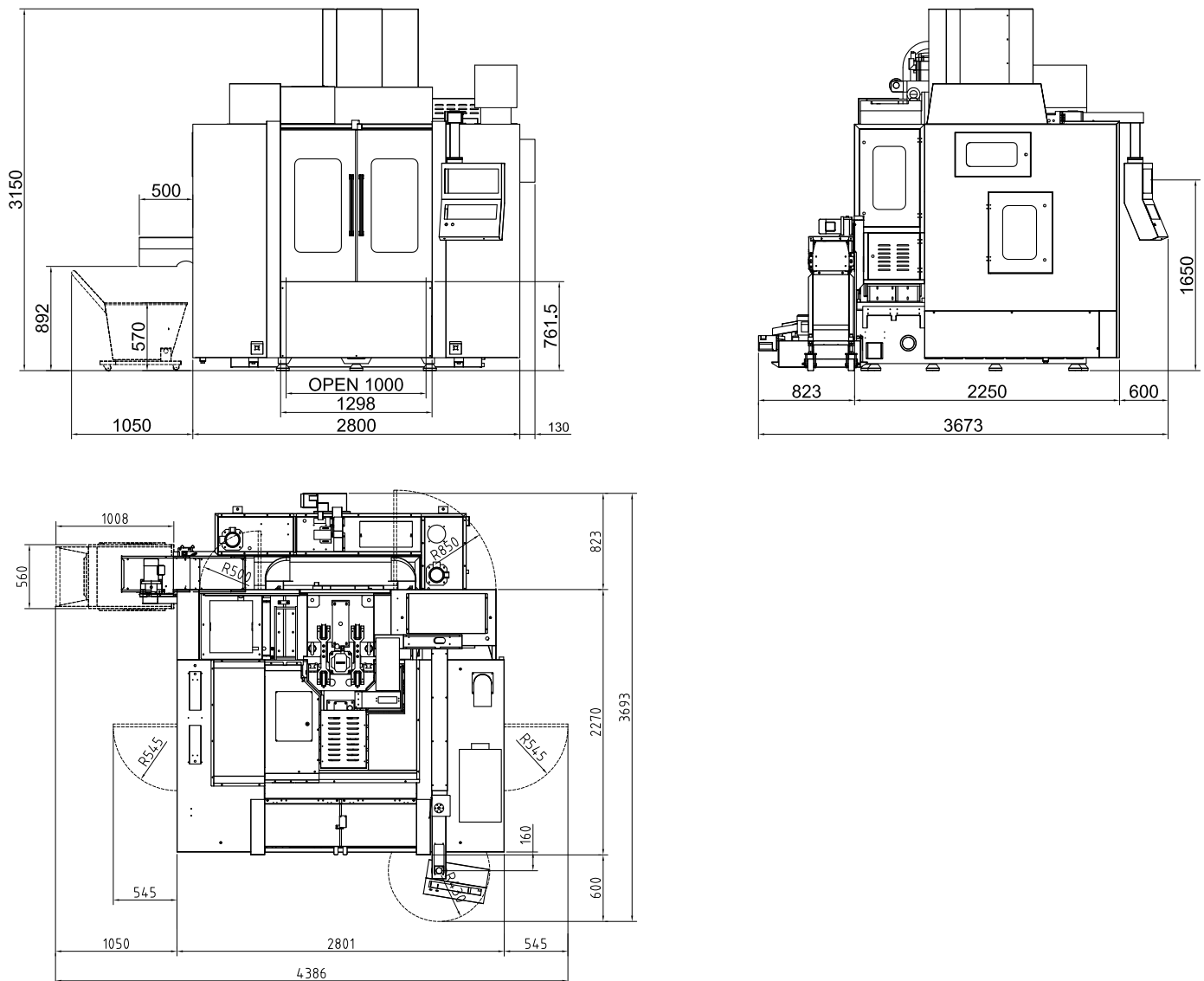

## Technical Specifications

Technical Specifications		VF900	VF1100	VF1300	VF1500
Table					
Table size	mm	1060 x 600	1300 x 600	1500 x 650	1700 x 700
T-slot (width x number x distance)	mm	18 x 5 x 100			18 x 6 x 100
Max. load	kg	800	1000	1200	1500
Travel					
X/Y/Z Travel	mm	900/600/600	1100/650/600	1300/650/600	1500/760/700
Spindle nose to table	mm	150 - 750			130 - 830
Spindle center to column	mm	652	697		802
Spindle					
Spindle (standard)	-	SK40/BBT40/CAT 40			
Spindle speed	rpm	12000	15000 (SIEMENS), 12000 (FANUC)		
Motor power/torque	-	9/22kW; 63/135Nm (SIEMENS) 11/18.5kW; 52.5/118Nm (FANUC)	20/53kW; 126/250Nm (SIEMENS) 15/30kW; 95.5/191Nm (FANUC)		
Spindle (option 1)	-	HSK A63, 20000rpm (SIEMENS)	HSK A63, 18000rpm (SIEMENS)		
Motor power/torque	-	20/24kW; 48/58Nm	30/36kW; 85/102Nm		
Spindle (option 2)	-	/	BBT50,10000 rpm (SIEMENS)		
Motor power/torque		/	20/53 kW;126/250Nm		
Feed					
Rapid feed X/Y/Z	m/min	36			24
Cutting feed	mm/min	1 - 12000			
Tool changer					
Number of tools	pcs	24			
Max. tool length	mm	300			
Max. tool diameter	mm	Φ78/Φ125			
Max. tool weight	kg	8			
Accuracy (VDI 3441 Full travel)					
Positioning accuracy (without linear scales)	mm	0.008		0.010	
Positioning repeatability (without linear scales)	mm	0.006		0.006	
Positioning accuracy (with linear scales)	mm	0.006		0.008	
Positioning repeatability (with linear scales)	mm	0.004		0.006	
Dimensions & Weight					
Dimensions	mm	3850×2340×3000	3850×3100×3185	4025×3090×3185	5180×2365×3170
Weight	kg	6500	7500	8000	10000



\* The above specifications are subject to change without prior notice, no liability for mistakes. Machines may be shown with optional equipment.



# UHP Center VF760



- Cast iron is tempered for stress relief to ensure structural stability without deformation
- C3 class ballscrews ensures the highest accuracy and durability
- Pre-tension on all axis minimizes thermal distortion



## Standard configuration

- ✓ Fully enclosed splash guard
- ✓ Direct drive spindle 12000 rpm
- ✓ 24 pockets arm tool changer
- ✓ Chain type chip conveyor
- ✓ Spindle oil cooler
- ✓ Air-conditioned electrical cabinet
- ✓ Rigid tapping
- ✓ Ethernet, CF card and USB interface
- ✓ Automatic lubrication system
- ✓ Coolant system
- ✓ LED working lamp
- ✓ End of program light
- ✓ Electronic handwheel (MPG)
- ✓ Tool box
- ✓ Leveling bolts and blocks
- ✓ Coolant gun
- ✓ Air gun
- ✓ Air blast during cutting
- ✓ User Manual

## Optional configuration

- Direct drive spindle 15000 rpm
- Built-in spindle 20000 rpm, HSK A63
- 28 pockets arm tool changer
- CTS coolant through spindle + ATS
- 4<sup>th</sup> axis
- 4/5<sup>th</sup> axis
- Workpiece probe
- Tool probe
- Linear scales on X/Y/Z axis
- Oil skimmer
- Extra 200GB SSD program memory (Only available on SIEMENS Control)

Technical Specifications		VF760
<b>Table</b>		
Table size	mm	900 x 420
T-slot (width x number x distance)	mm	14 x 3 x 125
Max. load	kg	500
<b>Travel</b>		
X/Y/Z Travel	mm	720/450/520
Spindle nose to table	mm	100 - 620
Spindle center to column	mm	517
<b>Spindle</b>		
Spindle taper	-	SK 40/BBT 40/CAT 40
Spindle speed	rpm	12000
Motor power/torque	-	9/22kW; 63/135Nm (SIEMENS) 11/18.5kW; 52.5/118Nm (FANUC)
Spindle (option)	-	HSK A63, 20000rpm (SIEMENS)
Motor power/torque	-	20/24kW; 48/58Nm
<b>Feed</b>		
Rapid feed X/Y/Z	m/min	48 (24 opt.)
Cutting feed	mm/min	1-12000
<b>Tool changer</b>		
Number of tools	pcs	24
Max. tool length	mm	300
Max. tool diameter	mm	Φ78/Φ125
Max. tool weight	kg	8
<b>Accuracy (VDI 3441 Full travel)</b>		
Positioning accuracy (without linear scales)	mm	0.008
Positioning repeatability (without linear scales)	mm	0.006
Positioning accuracy (with linear scales)	mm	0.006
Positioning repeatability (with linear scales)	mm	0.004
<b>Dimensions &amp; Weight</b>		
Dimensions	mm	3250×2710×2900
Weight	kg	4500

\* The above specifications are subject to change without prior notice, no liability for mistakes. Machines may be shown with optional equipment.

## Worktable

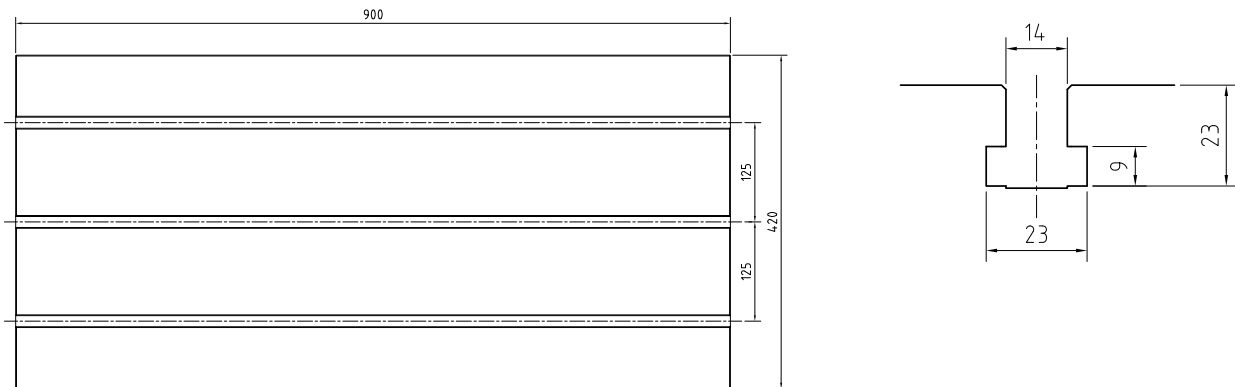

## Dimensions

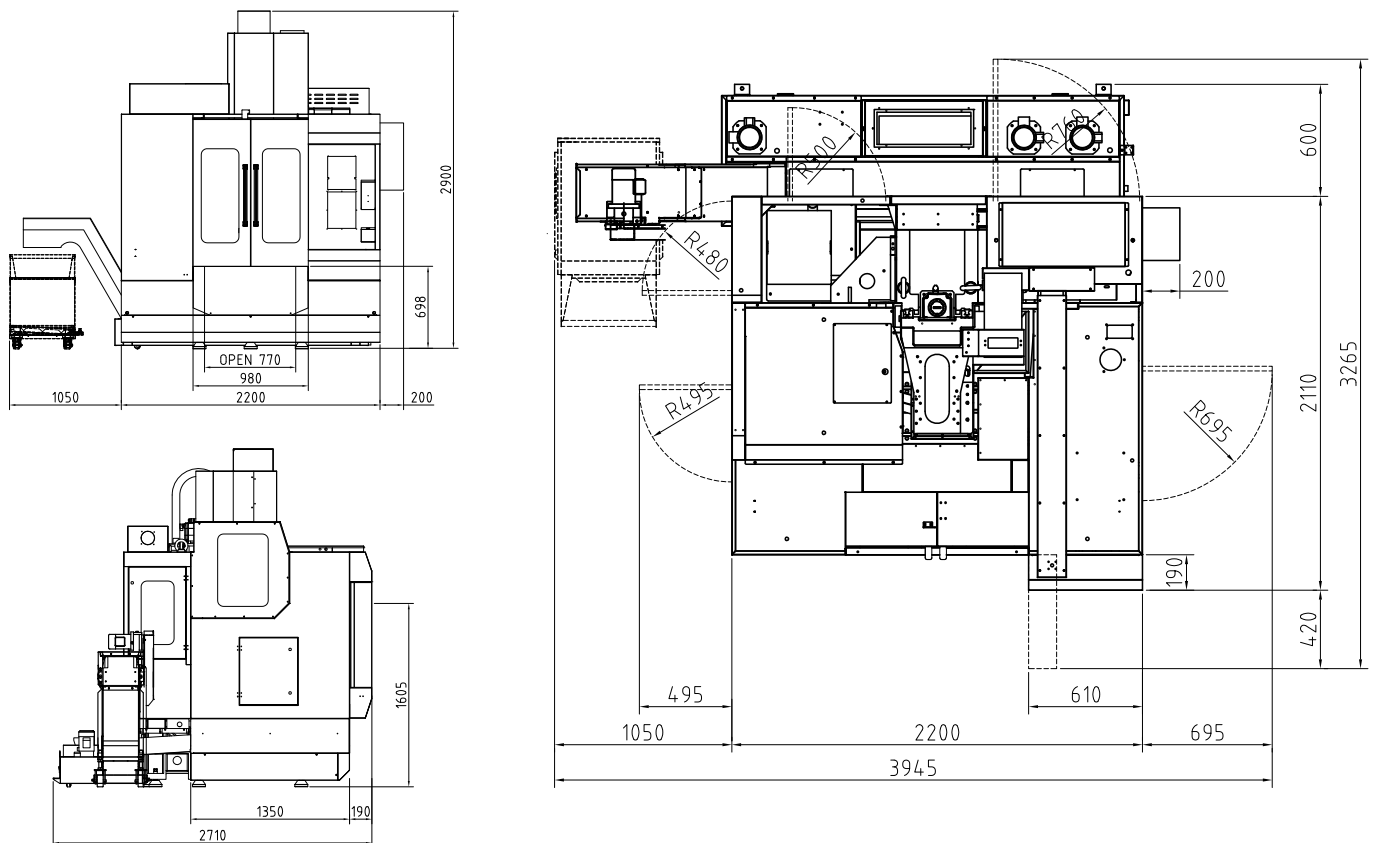

\* The above specifications are subject to change without prior notice, no liability for mistakes. Machines may be shown with optional equipment.

# MINI Center



- Training
- Tool room workshop
- Metal parts machining
- Model making
- R&D
- Cast iron is tempered for stress relief to ensure machine stability without deformation



Technical Specifications		Mini Center
<b>Table</b>		
Table size	mm	650 x 300
T-slot (width x number x distance)	mm	14 x 3 x 100
Max. load	kg	200
<b>Travel</b>		
X/Y/Z Travel	mm	500/300/400
Spindle nose to table	mm	120 - 520
Spindle center to column	mm	340
<b>Spindle</b>		
Spindle taper	-	SK 40/BT 40/CAT 40
Spindle motor power/torque	-	4.8/21kW; 19/45Nm (SIEMENS) 3.7/13kW; 23.6/82.8Nm (FANUC)
Spindle speed	rpm	10000
<b>Feed</b>		
Rapid speed	m/min	X/Y: 24, Z: 16
Cutting speed	mm/min	1-10000
<b>Tool changer</b>		
Number of tools	pcs	12
Max. tool length	mm	300
Max. tool diameter	mm	Φ90/Φ125
Max. tool weight	kg	8
<b>Accuracy (VDI 3441 Full travel)</b>		
Positioning accuracy	mm	0.010
Positioning repeatability	mm	0.008
<b>Dimensions &amp; Weight</b>		
Dimensions	mm	1660x2000x2495
Weight	kg	1800

## Standard configuration

- ✓ Fully enclosed splash guard
- ✓ Belt drive spindle 10000 rpm
- ✓ 12 position umbrella tool changer
- ✓ Spindle oil cooler
- ✓ Heat exchanger for electrical cabinet
- ✓ Rigid tapping
- ✓ Ethernet, CF card and USB interface
- ✓ Automatic lubrication system
- ✓ Coolant system
- ✓ LED working lamp
- ✓ End of program light
- ✓ Electronic handwheel (MPG)
- ✓ Tool box
- ✓ Leveling bolts and blocks
- ✓ Coolant gun
- ✓ Air gun
- ✓ Chip flushing system
- ✓ User Manual

## Optional configuration

- Workpiece probe
- Tool probe
- 4<sup>th</sup> axis
- Oil skimmer





12 position umbrella tool changer



LED Internal lamp



Chip flushing system



4<sup>th</sup> axis (optional)



Tool probe (optional)



Chip collector & Coolant tank

## Worktable

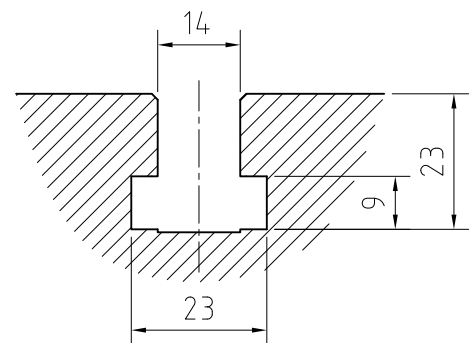
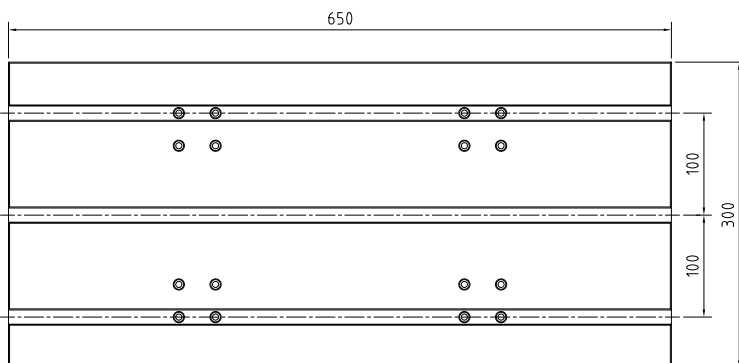

## Dimensions

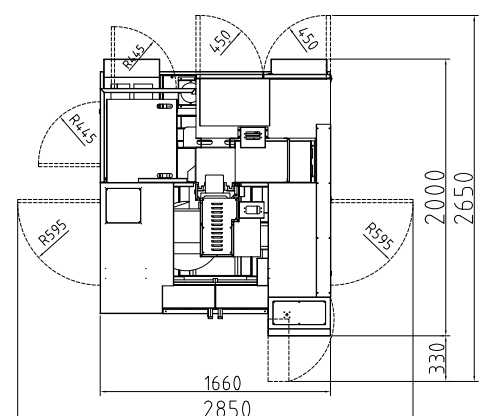
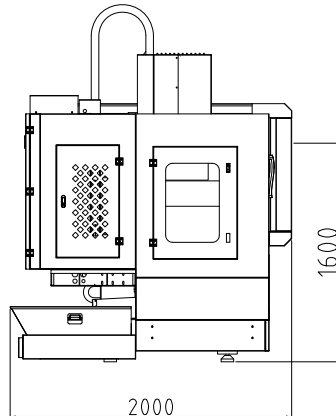
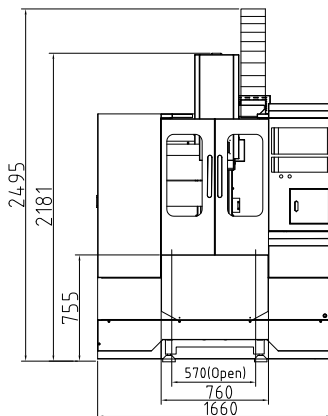

\* The above specifications are subject to change without prior notice, no liability for mistakes. Machines may be shown with optional equipment.

# Delta Center T7



- Highly rigid machine frame for high acceleration
- High speed and low noise ballscrew and linear guideways on three axes
- Rapid feed 48 m/min to reduce non-machining time



Technical specifications		T7
<b>Table</b>		
Table	mm	800 x 420
T-slot (width x number x distance)	mm	14 x 3 x 125
Max. load	kg	250
<b>Travel</b>		
X/Y/Z Travel	mm	700/450/300
Spindle nose to table	mm	150 - 450
Spindle center to column	mm	464
<b>Spindle</b>		
Spindle taper	-	BBT30
Spindle motor power/torque	kW	4.8/21kW; 19/45Nm (SIEMENS) 3.7/13kW; 23.6/82.8Nm (FANUC)
Spindle speed	rpm	12000
<b>Feed</b>		
Rapid feed X/Y/Z	m/min	48
Cutting feed	mm/min	1-12000
<b>Tool changer</b>		
Number of tools	pcs	21
Max. tool length	mm	200
Max. tool diameter	mm	60 (80)
Max. tool weight	kg	2
<b>Accuracy (VDI 3441 Full travel)</b>		
Positioning accuracy	mm	0.008
Positioning repeatability	mm	0.006
<b>Dimensions &amp; Weight</b>		
Dimensions	mm	2200x2460x2400
Weight	kg	3700

## Standard configuration:

- ✓ Fully enclosed splash guard
- ✓ Direct drive spindle 12000 rpm
- ✓ 21 pockets servo type tool changer
- ✓ Spindle oil cooler
- ✓ Heat exchanger for electrical cabinet
- ✓ Rigid tapping
- ✓ Ethernet and CF card and USB interface
- ✓ Automatic lubrication system
- ✓ Coolant system
- ✓ LED working lamp
- ✓ End of program light
- ✓ Electronic handwheel (MPG)
- ✓ Tool box
- ✓ Leveling bolts and blocks
- ✓ Coolant gun
- ✓ Air gun
- ✓ Chip flushing system
- ✓ User Manual

## Optional configuration:

- Direct drive spindle 20000 rpm
- Chain type chip conveyor
- 4<sup>th</sup> axis
- Workpiece probe
- Tool probe
- CTS Coolant through spindle + ATS
- Oil skimmer

## Worktable

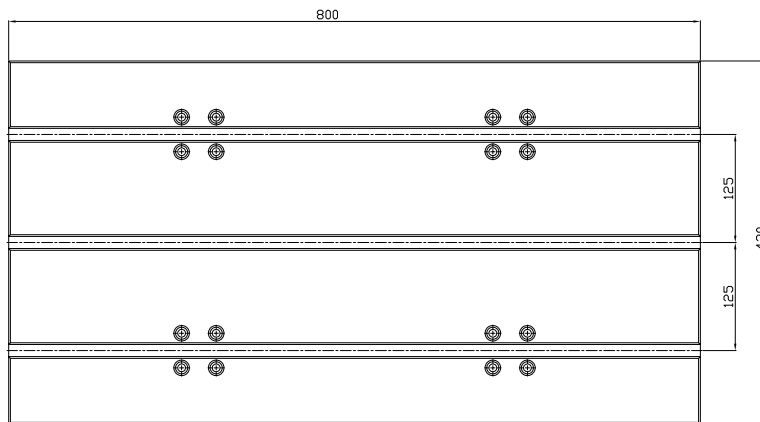

## Dimensions

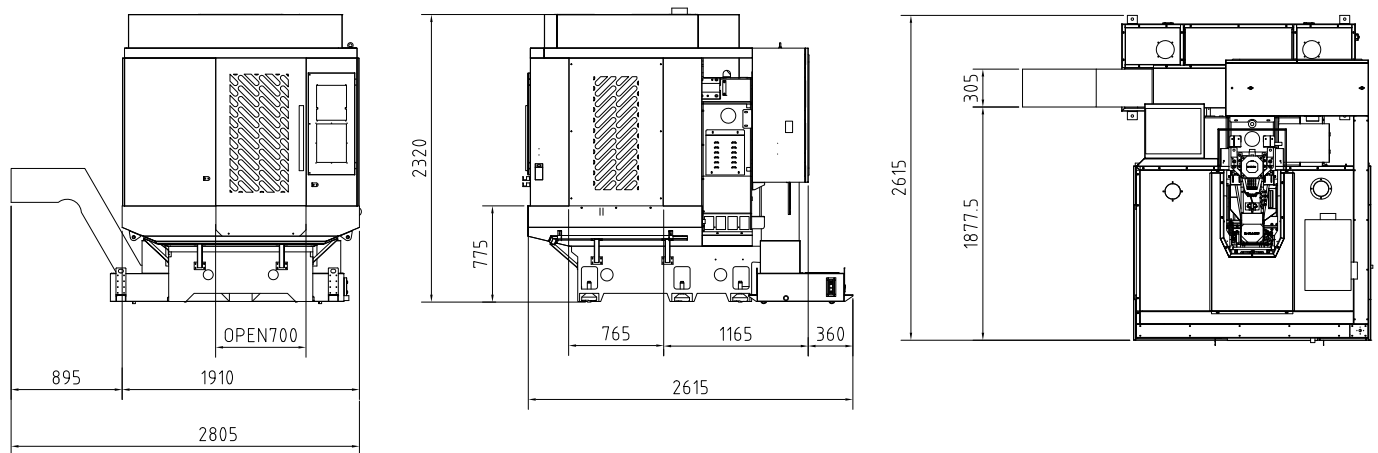

\* The above specifications are subject to change without prior notice, no liability for mistakes. Machines may be shown with optional equipment.



# Delta Center V7L Lite



- Toolroom workshop
- Metal parts machining
- Model making, R&D
- Cast iron is tempered for stress relief to ensure machine stability without deformation
- C3 class ballscrews ensures the highest accuracy and durability
- Pre-tension on all axes minimizes thermal distortion



Technical Specifications		Delta Center V7L Lite
<b>Table</b>		
Table size	mm	900 x 420
T-slot (width x number x distance)	mm	14 x 3 x 125
Max. load	kg	500
<b>Travel</b>		
X/Y/Z Travel	mm	760/450/520
Spindle nose to table	mm	100 - 620
Spindle center to column	mm	517
<b>Spindle</b>		
Spindle taper	-	SK 40/BT 40/CAT 40
Spindle speed	rpm	10000
Spindle motor power/torque	-	7.5/15kW; 36/72Nm (SIEMENS) 3.7/13kW; 23.6/82.8Nm (FANUC)
<b>Feed</b>		
Rapid feed X/Y/Z	m/min	30
Cutting speed	mm/min	1-12000
<b>Tool changer</b>		
Number of tools	pcs	24
Max. tool length	mm	300
Max. tool diameter	mm	Φ78 / Φ125
Max. tool weight	kg	8
<b>Accuracy (VDI 3441 Full travel)</b>		
Positioning accuracy	mm	0.008
Positioning repeatability	mm	0.006
<b>Dimensions &amp; Weight</b>		
Dimensions	mm	2900×2295×2900
Weight	kg	4500

## Standard configuration

- ✓ Fully enclosed splash guard
- ✓ Belt drive spindle 10000 rpm
- ✓ 24 pockets arm tool changer
- ✓ Screw type chip conveyor
- ✓ Spindle oil cooler
- ✓ Heat exchanger for electrical cabinet
- ✓ Rigid tapping
- ✓ Ethernet CF card and USB interface
- ✓ Automatic lubrication system
- ✓ Coolant system
- ✓ LED working lamp
- ✓ End of program light
- ✓ Electronic handwheel (MPG)
- ✓ Tool box
- ✓ Leveling bolts and blocks
- ✓ Coolant gun
- ✓ Air gun
- ✓ Chip flushing system
- ✓ User Manual

## Optional configuration

- CTS Coolant through spindle + ATS
- 4<sup>th</sup> axis
- Workpiece probe
- Tool probe
- Oil skimmer



24 pockets arm tool changer

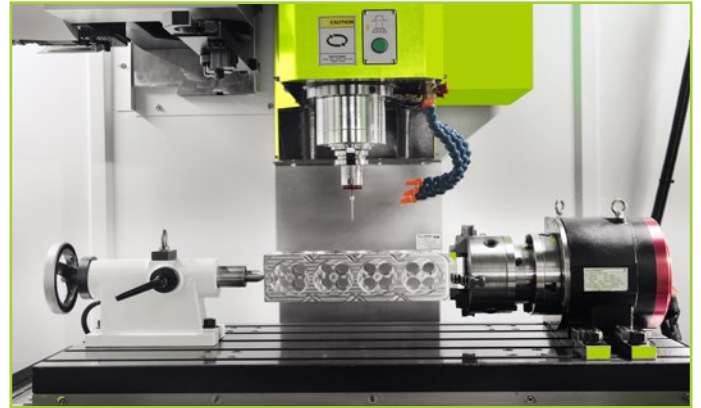

4<sup>th</sup> axis (optional)

## Worktable

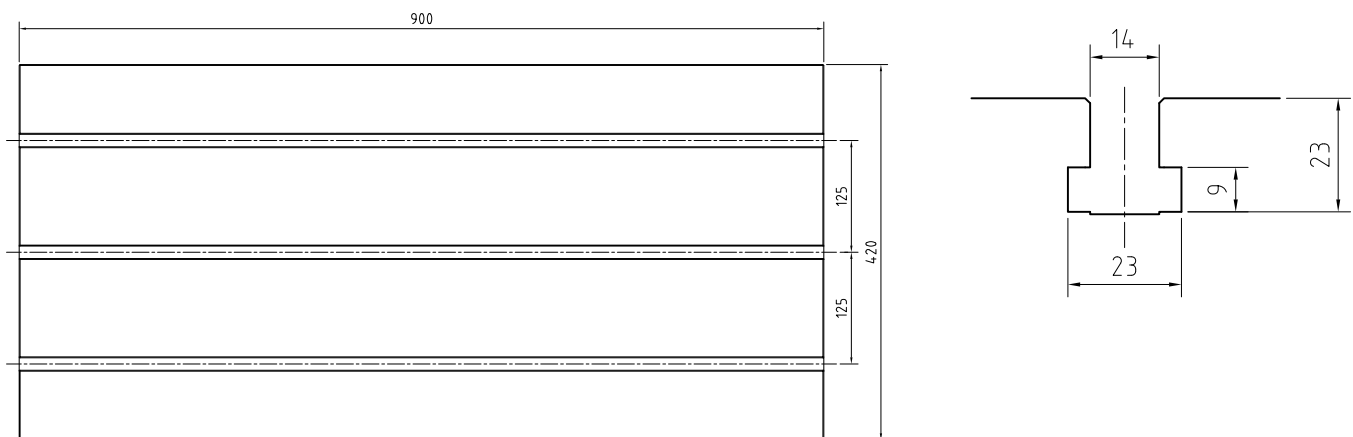

## Dimensions

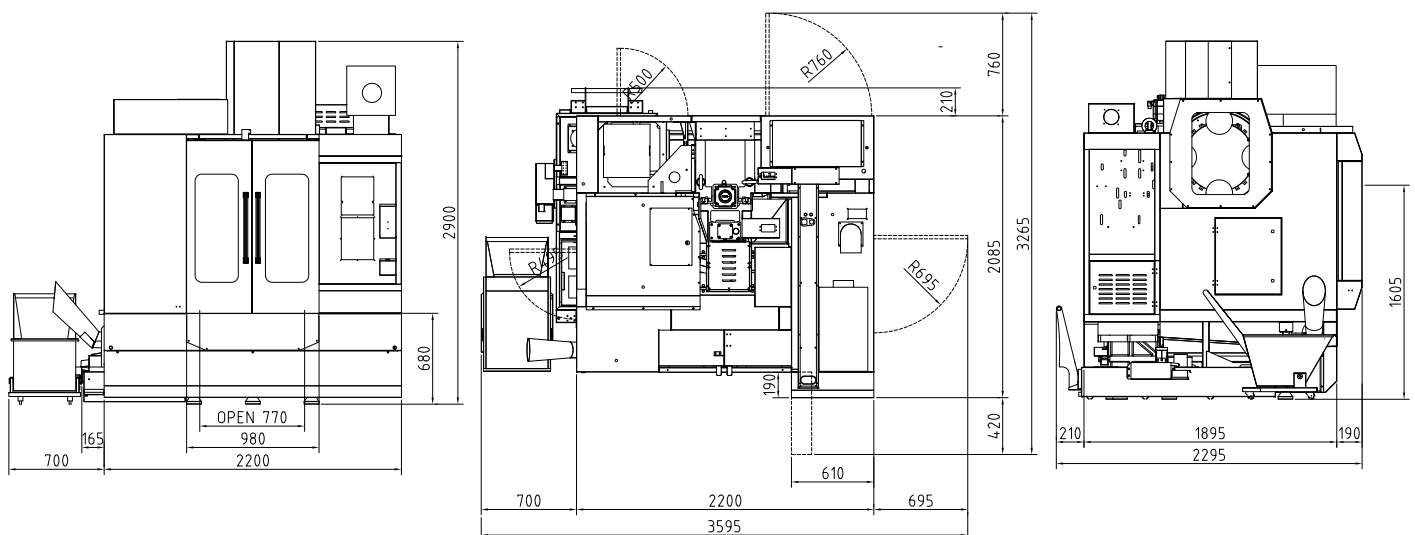

\* The above specifications are subject to change without prior notice, no liability for mistakes. Machines may be shown with optional equipment.

# Delta Center V10L



- Cast iron is tempered for stress relief to ensure structural stability without deformation
- Pre-tension on all axes minimizes thermal distortion
- C3 class ballscrews ensures the highest accuracy and durability

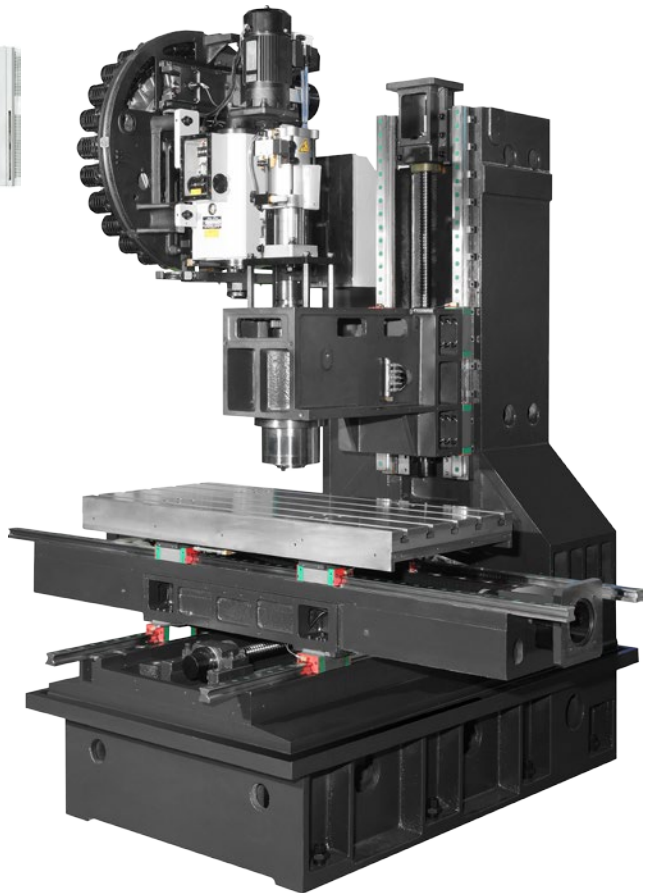

Technical Specifications		Delta Center V10L
<b>Table</b>		
Table size	mm	1100 x 500
T-slot (width x number x distance)	mm	18 x 5 x 100
Max. load	kg	600
<b>Travel</b>		
X/Y/Z Travel	mm	1020/530/560
Spindle nose to table	mm	115 - 675
Spindle center to column	mm	566
<b>Spindle</b>		
Spindle taper	-	SK 40/BT 40/CAT 40
Spindle speed	rpm	10000
Spindle motor power/torque	-	7.5/15kW; 36/72Nm (SIEMENS) 7.5/15kW; 35.8/95.5Nm (FANUC)
<b>Tool changer</b>		
Number of tools	pcs	24
Max. tool diameter	mm	Φ78 /Φ125
Max. tool length	mm	300
Max. tool weight	kg	8
<b>Feed</b>		
Rapid feed X/Y/Z	m/min	30
Cutting speed	mm/min	1-12000
<b>Accuracy (VDI 3441 Full travel)</b>		
Positioning accuracy	mm	0.010
Positioning repeatability	mm	0.006
<b>Dimensions &amp; Weight</b>		
Dimensions	mm	3870×2175×2850
Weight	kg	5000

## Standard configuration

- ✓ Fully enclosed splash guard
- ✓ Belt drive spindle 10000 rpm
- ✓ 24 pockets arm tool changer
- ✓ Chain type chip conveyor
- ✓ Spindle oil cooler
- ✓ Air-conditioned electrical cabinet
- ✓ Rigid tapping
- ✓ Ethernet, CF card and USB interface
- ✓ Automatic lubrication system
- ✓ Coolant system
- ✓ LED working lamp
- ✓ End of program light
- ✓ Electronic handwheel (MPG)
- ✓ Tool box
- ✓ Leveling bolts and blocks
- ✓ Coolant gun
- ✓ Air gun
- ✓ Chip flushing system
- ✓ User Manual

## Optional configuration

- Direct drive spindle 12000 rpm
- CTS Coolant through spindle + ATS
- Oil skimmer
- Workpiece probe
- Tool probe
- 4<sup>th</sup> axis
- 4/5<sup>th</sup> axis



## Worktable

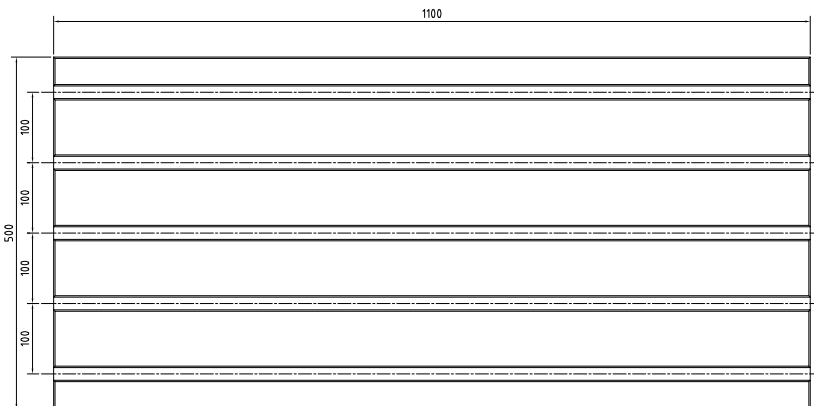

## Dimensions

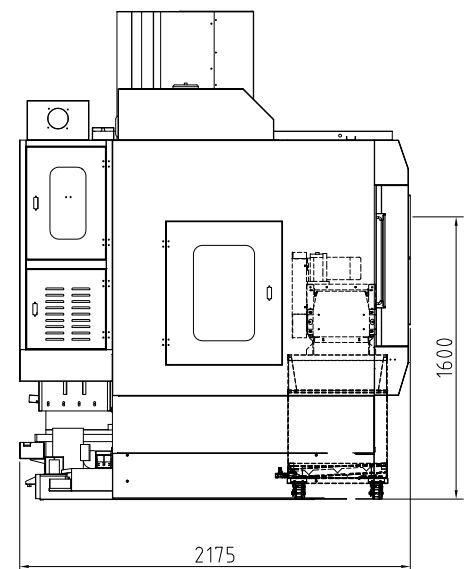
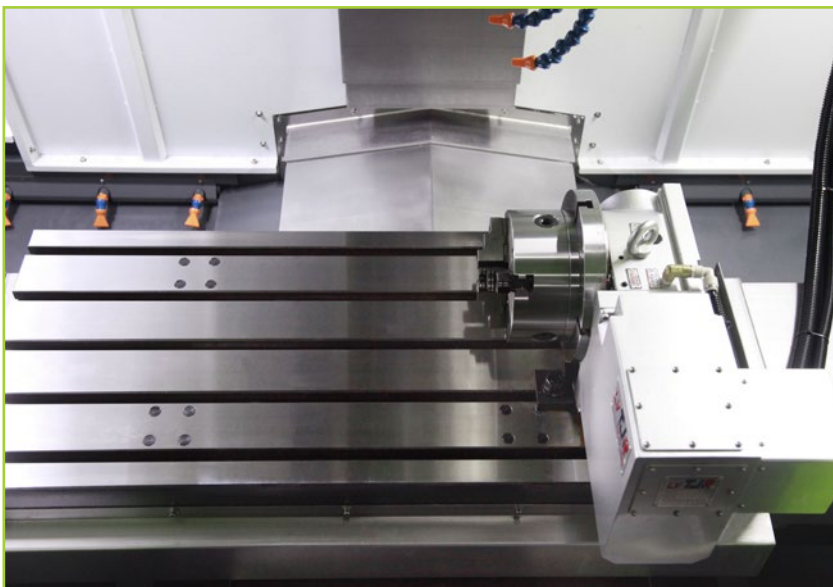
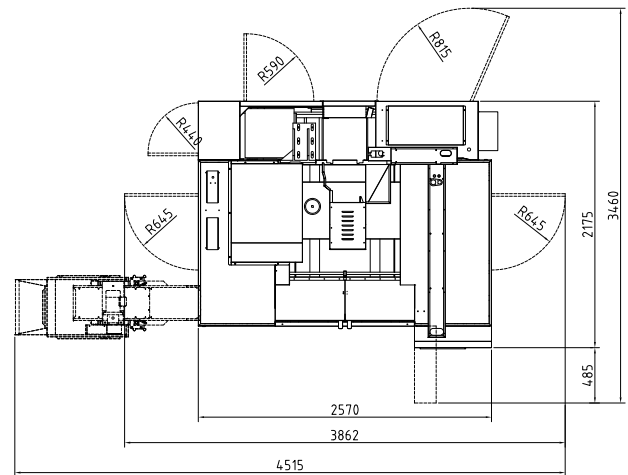
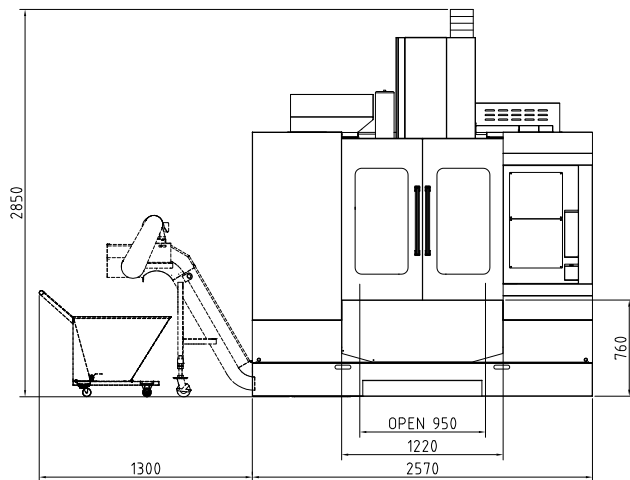

4<sup>th</sup> axis, different sizes

\* The above specifications are subject to change without prior notice, no liability for mistakes. Machines may be shown with optional equipment.

# Alpha Center V7L



Technical Specifications		Alpha Center V7L
<b>Table</b>		
Table size	mm	900 x 420
T-slot (width x number x distance)	mm	14 x 3 x 125
Max. load	kg	500
<b>Travel</b>		
X/Y/Z Travel	mm	760/450/520
Spindle nose to table	mm	100 - 620
Spindle center to column	mm	517
<b>Spindle</b>		
Spindle taper	-	SK 40/BT 40/CAT 40
Spindle speed	rpm	10000
Spindle motor power/torque	-	9/22kW; 63/135Nm (SIEMENS) 7.5/15kW; 35.8/95.5Nm (FANUC)
<b>Feed</b>		
Rapid feed X/Y/Z	m/min	48
Cutting speed	mm/min	1-12000
<b>Tool changer</b>		
Number of tools	pcs	24
Max. tool length	mm	300
Max. tool diameter	mm	Φ78 /Φ125
Max. tool weight	kg	8
<b>Accuracy (VDI 3441 Full travel)</b>		
Positioning accuracy	mm	0.008
Positioning repeatability	mm	0.006
<b>Dimensions &amp; Weight</b>		
Dimensions	mm	3250x2710x2900
Weight	kg	4500



## Standard configuration

- ✓ Fully enclosed splash guard
- ✓ Belt drive spindle 10000 rpm
- ✓ 24 pockets arm tool changer
- ✓ Chain type chip conveyor
- ✓ Spindle oil cooler
- ✓ Air-conditioned electrical cabinet
- ✓ Rigid tapping
- ✓ Ethernet CF card and USB interface
- ✓ Automatic lubrication system
- ✓ Coolant system
- ✓ LED working lamp
- ✓ End of program light
- ✓ Electronic handwheel (MPG)
- ✓ Tool box
- ✓ Leveling bolts and blocks
- ✓ Coolant gun
- ✓ Air gun
- ✓ Chip flushing system
- ✓ User Manual

## Optional configuration

- Direct drive spindle 12000 rpm
- 28 pockets arm tool changer
- CTS Coolant through spindle + ATS
- Oil skimmer
- Workpiece probe
- Tool probe
- 4<sup>th</sup> axis
- 4/5<sup>th</sup> axis
- Extra 200GB SSD program memory (Only available on SIEMENS Control)





# Alpha Center V11L



- Cast iron is tempered for stress relief to ensure structural stability without deformation
- C3 class ballscrews ensures the highest accuracy and durability
- Pre-tension on all axis minimizes thermal distortion



Technical Specifications		V11L
<b>Table</b>		
Table size	mm	1200 x 600
T-slots (width x number x distance)	mm	18 x 5 x 100
Max. load	kg	1000
<b>Travel</b>		
X/Y/Z Travel	mm	1100/600/600
Spindle nose to table	mm	150 - 750
Spindle center to column	mm	652
<b>Spindle</b>		
Spindle taper	-	SK 40/BT 40/CAT 40
Spindle motor power/torque	-	9/22kW; 63/135Nm (SIEMENS) 11/18.5kW; 52.5/118Nm (FANUC)
Spindle speed	rpm	10000
<b>Feed</b>		
Rapid feed X/Y/Z	m/min	36
Cutting speed	mm/min	1-12000
<b>Tool changer</b>		
Number of tools	pcs	24
Max. tool length	mm	300
Max. tool diameter	mm	Φ78/Φ125
Max. Weight	kg	8
<b>Accuracy (VDI 3441 Full travel)</b>		
Positioning accuracy	mm	0.008
Positioning repeatability	mm	0.006
<b>Dimensions &amp; Weight</b>		
Dimensions	mm	3845x2320x3120
Weight	kg	6500

## Standard configuration

- ✓ Fully enclosed splash guard
- ✓ Belt drive spindle 10000 rpm
- ✓ 24 pockets arm tool changer
- ✓ Chain type chip conveyor
- ✓ Spindle oil cooler
- ✓ Air-conditioned for electrical cabinet
- ✓ Rigid tapping
- ✓ Ethernet, CF card and USB interface
- ✓ Automatic lubrication system
- ✓ Coolant system
- ✓ LED working lamp
- ✓ End of program light
- ✓ Electronic handwheel (MPG)
- ✓ Tool box
- ✓ Leveling bolts and blocks
- ✓ Coolant gun
- ✓ Air gun
- ✓ Chip flushing system
- ✓ User Manual

## Optional configuration

- Direct drive spindle 12000 rpm
- Direct drive spindle 15000 rpm
- 28 pockets arm tool changer
- CTS Coolant through spindle + ATS
- Oil skimmer
- Workpiece probe
- Tool probe
- 4<sup>th</sup> axis
- 4/5<sup>th</sup> axis
- Extra 200GB SSD program memory (Only available on SIEMENS Control)



# Alpha Center V13L



- Cast iron is tempered for stress relief to ensure structural stability without deformation
- C3 class ballscrews ensures the highest accuracy and durability
- Pre-tension on all axis minimizes thermal distortion



Technical Specifications		V13L
<b>Table</b>		
Table size	mm	1500 x 650
T-slot (width x number x distance)	mm	18 x 5 x 100
Max. load	kg	1200
<b>Travel</b>		
X/Y/Z Travel	mm	1300/650/600
Spindle nose to table	mm	150 - 750
Spindle center to column	mm	697
<b>Spindle</b>		
Spindle taper	-	SK40/BT40/CAT40
Spindle speed	rpm	10000
Spindle motor power/torque	-	20/53kW; 126/250Nm (SIEMENS) 11/18.5kW; 52.5/118Nm (FANUC)
<b>Tool changer</b>		
Number of tools	pcs	24
Max. tool length	mm	300
Max. tool diameter	mm	Φ78/Φ125
Max. tool Weight	kg	8
<b>Feed</b>		
Rapid feed X/Y/Z	m/min	36/36/24
Cutting speed	mm/min	1-12000
<b>Accuracy (VDI 3441 Full travel)</b>		
Positioning accuracy	mm	0.010
Positioning repeatability	mm	0.006
<b>Dimnesions &amp; Weight</b>		
Dimensions	mm	4025x3090x3185
Weight	kg	8000

## Standard configuration

- ✓ Fully enclosed splash guard
- ✓ Belt drive spindle 10000 rpm
- ✓ 24 pockets arm tool changer
- ✓ Chain type chip conveyor
- ✓ Spindle oil cooler
- ✓ Air-conditioned electrical cabinet
- ✓ Rigid tapping
- ✓ Ethernet, CF card and USB interface
- ✓ Automatic lubrication system
- ✓ Coolant system
- ✓ LED working lamp
- ✓ End of program light
- ✓ Electronic handwheel (MPG)
- ✓ Tool box
- ✓ Leveling bolts and blocks
- ✓ Coolant gun
- ✓ Air gun
- ✓ Air blast during cutting
- ✓ User Manual

## Optional configuration

- Direct drive spindle 12000rpm, taper 40
- Direct drive spindle 15000rpm, taper 40(SIEMENS)
- Direct drive spindle 8000rpm\_15/20.3kW, BBT50(FANUC)
- Direct drive spindle 10000 rpm\_53kW\_BBT50(SIEMENS)
- Belt drive spindle 8000 rpm\_15/20.3kW, BT50/SK50(FANUC)
- Belt drive spindle 8000 rpm\_20/53kW, BT50/SK50(SIEMENS)
- Belt drive spindle with BF gearbox 6000 rpm
- 28 pockets arm tool changer ,taper 40
- 40 pockets chain type tool changer ,taper 40
- CTS Coolant through spindle + ATS
- Oil skimmer
- Workpiece probe
- Tool probe
- 4<sup>th</sup> axis
- 4/5<sup>th</sup> axis
- Extra 200GB SSD program memory (Only available on SIEMENS Control)

\* The above specifications are subject to change without prior notice, no liability for mistakes. Machines may be shown with optional equipment.



## Worktable

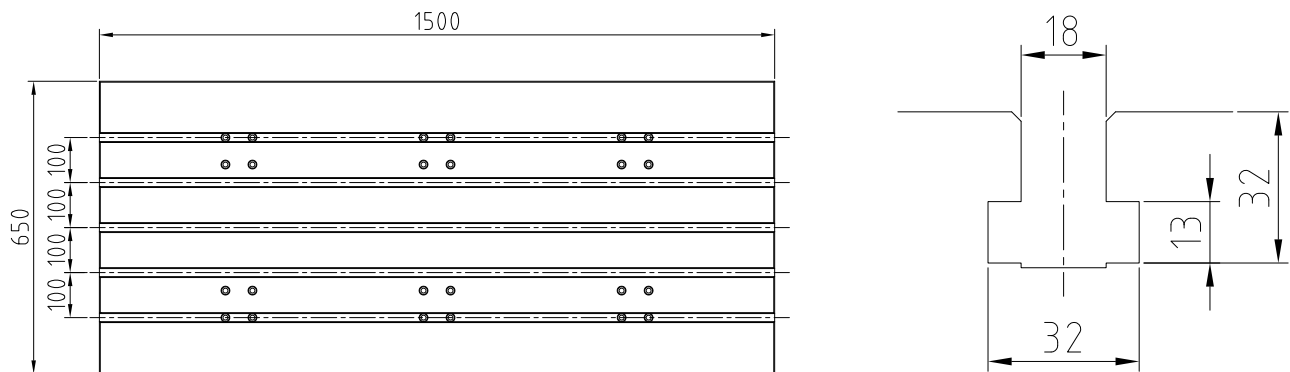

## Dimensions

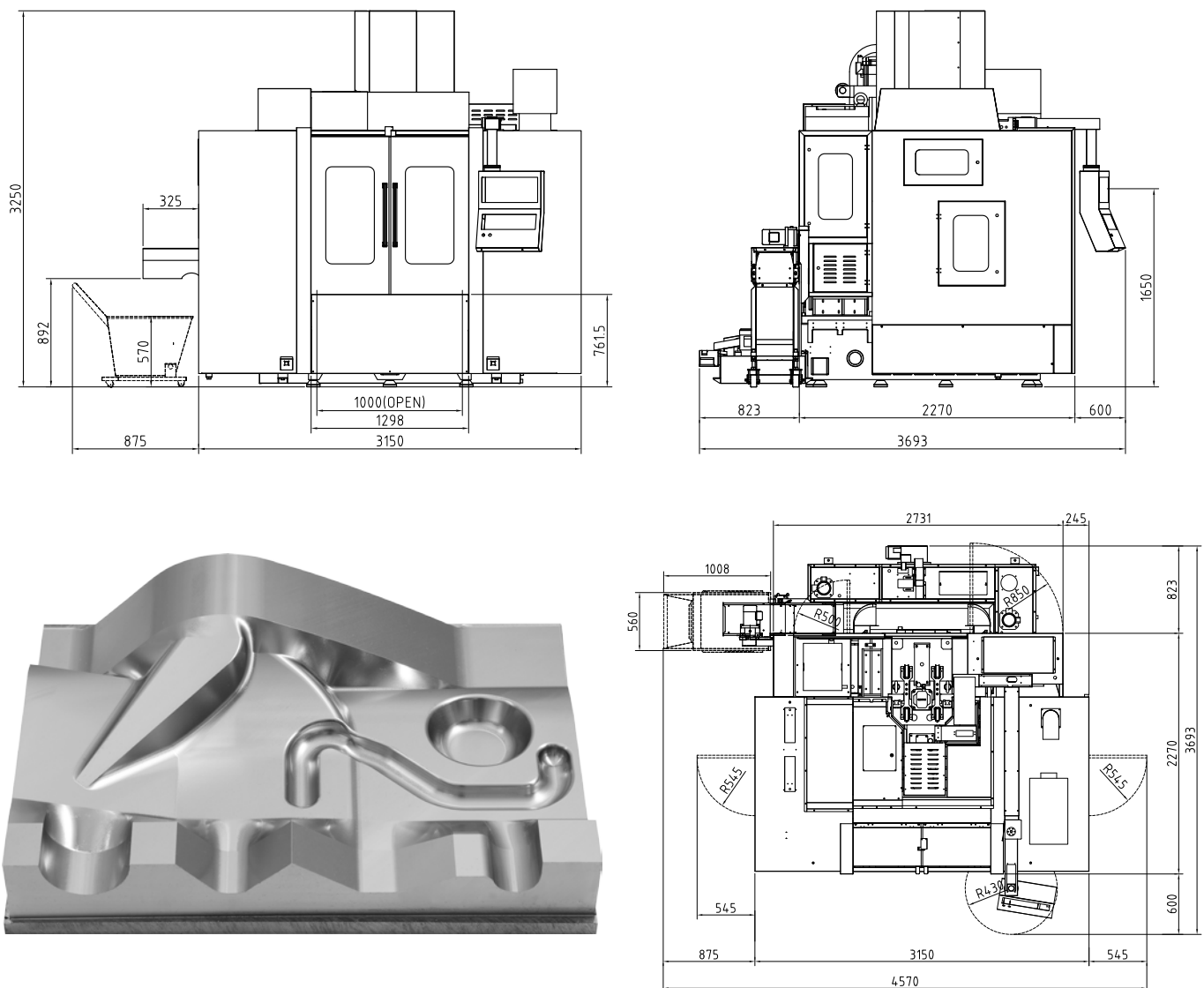

\* The above specifications are subject to change without prior notice, no liability for mistakes. Machines may be shown with optional equipment.

# Alpha Center V15L



- 4 linear guideways on Y axis
- Cast iron is tempered for stress relief to ensure structural stability without deformation
- C3 class ballscrews ensures the highest accuracy and durability
- Pre-tension on all axis minimizes thermal distortion

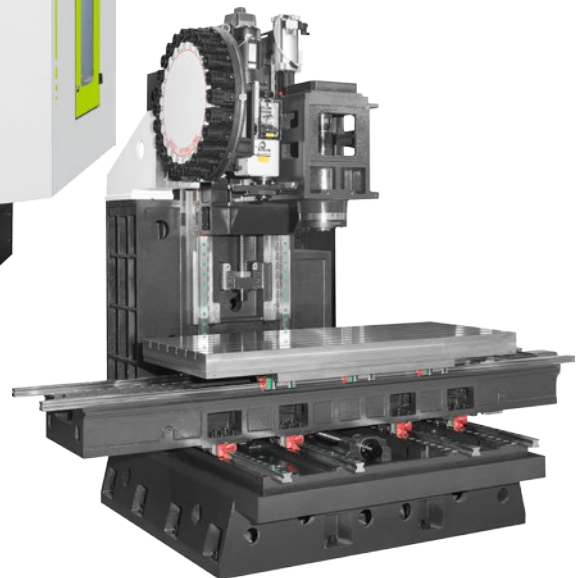

Technical Specifications		V15L
<b>Table</b>		
Table size	mm	1700 x 700
T-slot (width x number x distance)	mm	18 x 6 x 100
Max. load	kg	1500
<b>Travel</b>		
X/Y/Z Travel	mm	1500/760/700
Spindle nose to table	mm	130 - 830
Spindle center to column	mm	802
<b>Spindle</b>		
Spindle tapper	-	SK40/BT40/CAT40
Spindle speed	rpm	10000
Spindle motor power/torque	-	20/53kW; 126/250Nm (SIEMENS) 11/18.5kW; 52.5/118Nm (FANUC)
<b>Tool changer</b>		
Number of tools	pcs	24
Max. tool length	mm	300
Max. tool diameter	mm	Φ78/Φ125
Max. tool Weight	kg	8
<b>Feed</b>		
Rapid feed X/Y/Z	m/min	24/24/24
Cutting speed	mm/min	1-12000
<b>Accuracy (VDI 3441 Full travel)</b>		
Positioning accuracy	mm	0.010
Positioning repeatability	mm	0.006
<b>Dimnesions &amp; Weight</b>		
Dimensions	mm	5180x2365x3170
Weight	kg	10000

## Standard configuration

- ✓ Fully enclosed splash guard
- ✓ Belt drive spindle 10000 rpm
- ✓ 24 pockets arm tool changer
- ✓ Chain type chip conveyor
- ✓ Spindle oil cooler
- ✓ Air-conditioned electrical cabinet
- ✓ Rigid tapping
- ✓ Ethernet, CF card and USB interface
- ✓ Automatic lubrication system
- ✓ Coolant system
- ✓ LED working lamp
- ✓ End of program light
- ✓ Electronic handwheel (MPG)
- ✓ Tool box
- ✓ Leveling bolts and blocks
- ✓ Coolant gun
- ✓ Air gun
- ✓ Air blast during cutting
- ✓ User Manual

## Optional configuration

- Direct drive spindle 12000rpm, taper 40
- Direct drive spindle 15000rpm, taper 40(SIEMENS)
- Direct drive spindle 8000rpm\_15/20.3kW, BBT50(FANUC)
- Direct drive spindle 10000 rpm\_20/53kW\_BBT50(SIEMENS)
- Belt drive spindle 6000 rpm\_15/20.3kW, BT50/SK50(FANUC)
- Belt drive spindle 6000 rpm\_20/53kW, BT50/SK50(SIEMENS)
- Belt drive spindle with BF gearbox 6000 rpm
- 28 pockets arm tool changer ,taper 40
- 40 pockets chain type tool changer ,taper 40
- CTS Coolant through spindle + ATS
- Oil skimmer
- Workpiece probe
- Tool probe
- 4<sup>th</sup> axis
- 4/5<sup>th</sup> axis
- Extra 200GB SSD program memory (Only available on SIEMENS Control)

## Worktable

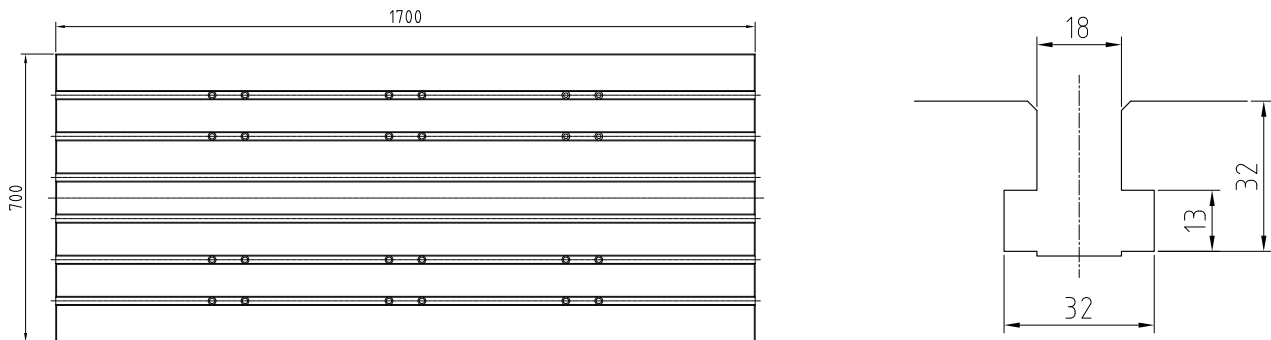

## Dimensions

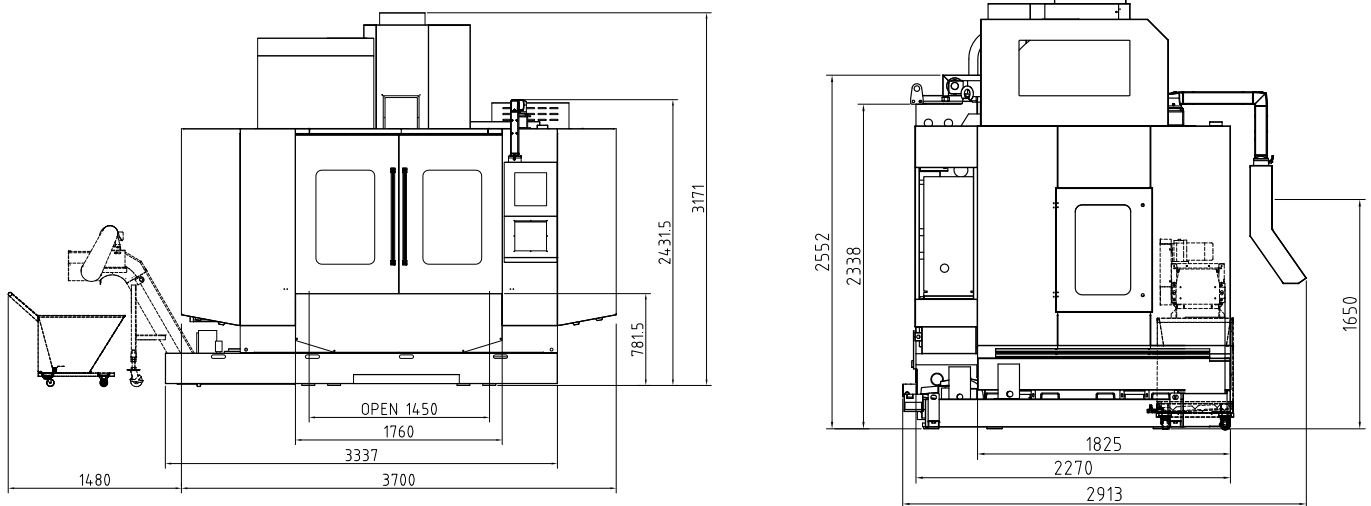

5<sup>th</sup> axis, different sizes

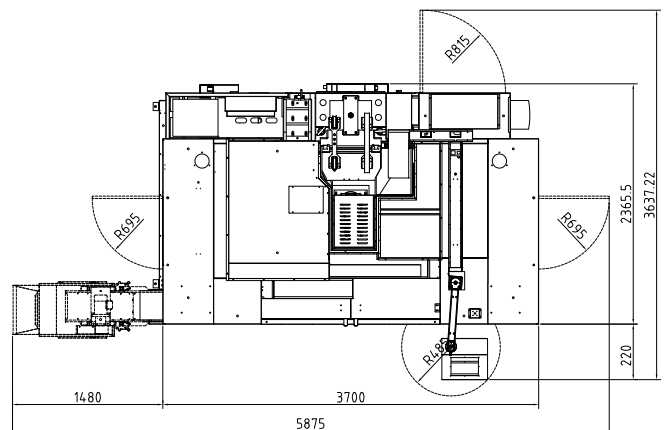

\* The above specifications are subject to change without prior notice, no liability for mistakes. Machines may be shown with optional equipment.



# Power Center V18

- Best choice for super heavy duty cutting with large workpiece
- X and Y axis with roller type linear guideways and Z axis with boxway guideways
- 50 taper spindle with belt drive 6000 rpm as standard, and optional with gearbox



- C3 class ballscrews ensures the highest accuracy and durability
- Pre-tension on all axis minimizes thermal distortion

Technical Specifications		Power Center V18
<b>Table</b>		
Table size	mm	2000 x 900
T-slot (width x number x distance)	mm	22 x 5 x 165
Max. load	kg	2000
<b>Travel</b>		
X/Y/Z Travel	mm	1800/900/800
Spindle nose to table	mm	160 - 960
Spindle center to column	mm	950
<b>Spindle</b>		
Spindle taper	-	SK 50/BT 50/CAT 50
Spindle motor power/torque	-	17/42kW; 183/400Nm (SIEMENS) 15/20.3kW; 143/259Nm (FANUC)
Spindle speed	rpm	6000
<b>Feed</b>		
Rapid speed X/Y/Z	m/min	20/20/15
Cutting speed	mm/min	1-12000
<b>Tool changer</b>		
Number of tools	pcs	24
Max. tool length	mm	400
Max. tool diameter	mm	Φ125/Φ245
Max. tool weight	kg	15
<b>Accuracy (VDI 3441 Full travel)</b>		
Positioning accuracy	mm	0.016
Positioning repeatability	mm	0.010
<b>Dimensions &amp; Weight</b>		
Dimensions	mm	5722x3335x3440
Weight	kg	17500

## Standard configuration

- ✓ Fully enclosed splash guard
- ✓ Belt drive spindle 6000 rpm
- ✓ 24 pockets arm tool changer
- ✓ Two screw type and one chain type chip conveyor
- ✓ Spindle oil cooler
- ✓ Air-conditioned electrical cabinet
- ✓ Rigid tapping
- ✓ Ethernet, CF card and USB interface
- ✓ Automatic lubrication system
- ✓ Coolant system
- ✓ LED working lamp
- ✓ End of program light
- ✓ Electronic handwheel (MPG)
- ✓ Tool box
- ✓ Leveling bolts and blocks
- ✓ Coolant gun
- ✓ Air gun
- ✓ Air blast during cutting
- ✓ User Manual

## Optional configuration

- Gear box spindle 6000 rpm
- 32 pockets chain type tool changer
- CTS Coolant through spindle + ATS
- Oil skimmer
- Workpiece probe
- Tool probe
- 4<sup>th</sup> axis
- 4/5<sup>th</sup> axis
- Extra 200GB SSD program memory (Only available on SIEMENS Control)

## Worktable

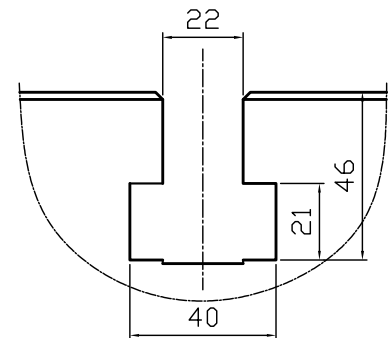
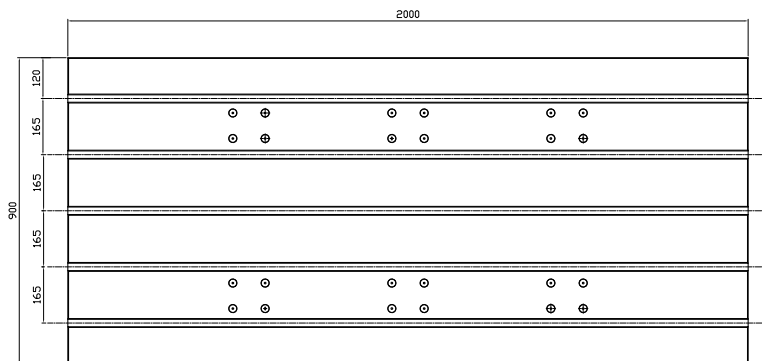

## Dimensions

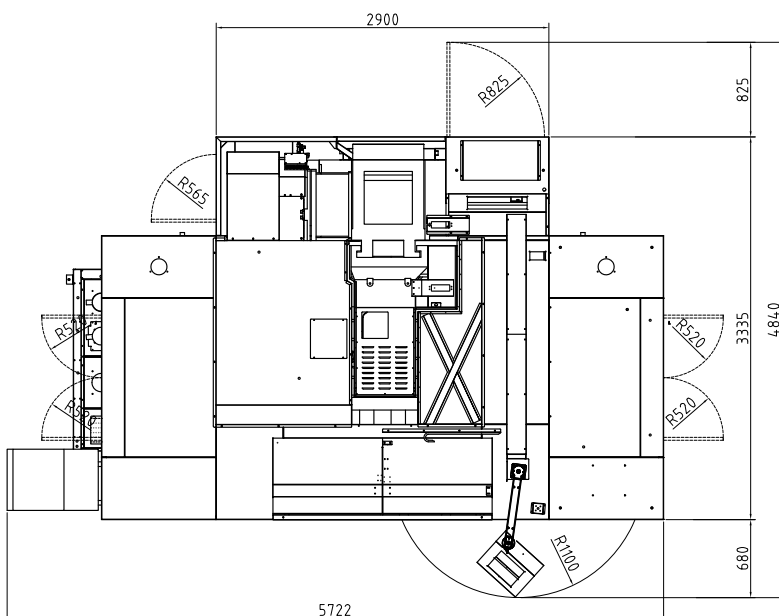
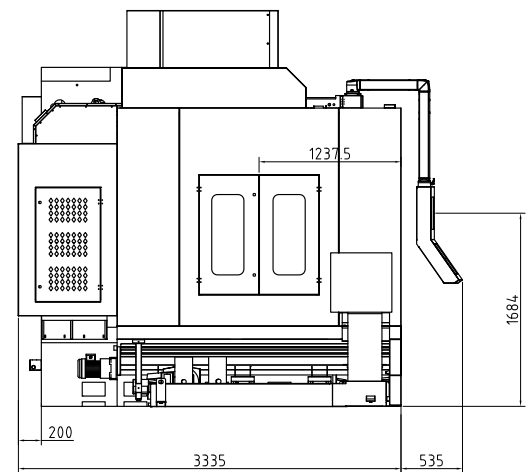
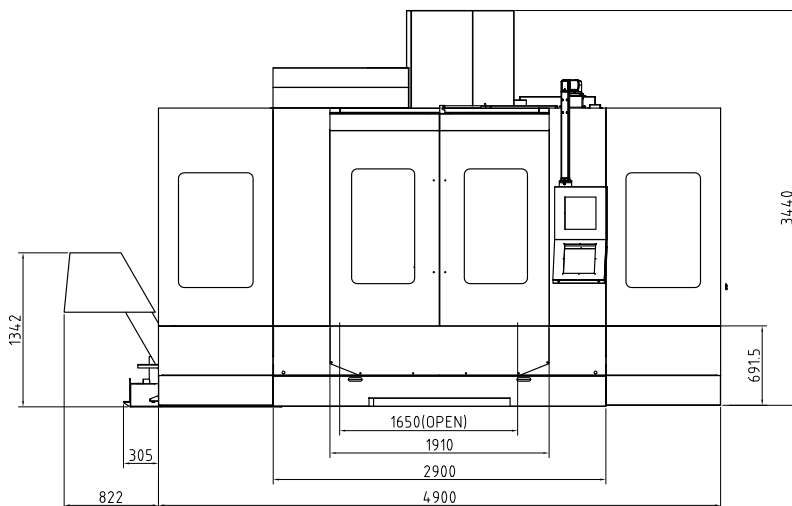

\* The above specifications are subject to change without prior notice, no liability for mistakes. Machines may be shown with optional equipment.

# Double Column Center V1613HS



- Cast iron is tempered for stress relief to ensure structural stability without deformation
- C3 class ballscrews ensures the highest accuracy and durability
- Pre-tension on all axes minimizes thermal distortion
- Roller type linear guideway, which offers super high rigidity and loading capacity

## Standard configuration

- ✓ Fully enclosed splash guard
- ✓ Direct drive spindle 12000 rpm
- ✓ Air-conditioned electrical cabinet
- ✓ Rigid tapping
- ✓ Two screw type and one chain type chip conveyor
- ✓ Ethernet, CF card and USB interface
- ✓ Automatic lubrication system
- ✓ Coolant system
- ✓ Spindle oil cooler
- ✓ LED working lamp
- ✓ End of program light
- ✓ Electronic handwheel (MPG)
- ✓ Tool box
- ✓ Leveling bolts and blots
- ✓ Coolant gun
- ✓ Air gun
- ✓ User Manual

## Optional configuration

- Direct drive spindle 15000 rpm
- Built-in spindle 18000 rpm HSK A63, 30/36kW\_85/102Nm
- 32 pockets arm tool changer
- CTS coolant through spindle +ATS
- Linear scales
- Oil skimmer
- Extra 200GB SSD program memory (Only available on SIEMENS Control)

Technical Specifications		V1613HS
<b>Table</b>		
Table size	mm	1700 x 1200
T-slot (width x number x distance)	mm	18 x 7 x 150
Max. load	kg	3000
<b>Travel</b>		
X/Y/Z Travel	mm	1600/1300/600
Spindle nose to table	mm	200 - 800
Distance between columns	mm	1380
<b>Spindle</b>		
Spindle taper	-	SK40/BT40/CAT40
Spindle motor power/ torque	-	9/22kW; 63/135Nm (SIEMENS) 11/18.5kW; 52.5/118Nm (FANUC)
Spindle speed	rpm	12000
Spindle transmission	-	direct drive
<b>Feed</b>		
Rapid feed X/Y/Z	m/min	20
Cutting speed	mm/min	1-12000

Technical Specifications		V1613HS
<b>Tool changer</b>		
Number of tools	pcs	32 (option)
Max. tool length	mm	300
Max. tool diameter	mm	Φ78/Φ125
Max. tool weight	kg	8
<b>Accuracy (VDI 3441 Full travel)</b>		
Positioning accuracy (without linear scales)	mm	0.012
Positioning repeatability (without linear scales)	mm	0.010
Positioning accuracy (with linear scales)	mm	0.010
Positioning repeatability (with linear scales)	mm	0.008
<b>Dimensions &amp; Weight</b>		
Dimensions	mm	4890x4110x3650
Weight	kg	16000

\* The above specifications are subject to change without prior notice, no liability for mistakes. Machines may be shown with optional equipment.





# Double Column Center V2516

- Extra wide column to increase connection surface with the crossbeam to avoid vibration during cutting.
- X/Y axis with roller type linear guideways and Z axis with boxway guideways, as standard with belt drive spindle.
- For optional with built-in spindle, all 3 axis are with roller type linear guideways.



Technical Specifications		V2516
<b>Table</b>		
Table size	mm	2500×1400
T-slot (width x number x distance)	mm	22×7×170
Max. load	kg	7000
<b>Travel</b>		
X/Y/Z Travel	mm	2500/1600/800
Spindle nose to table	mm	270-1070
Distance between columns	mm	1600
<b>Spindle</b>		
Spindle speed	rpm	BT50/SK50, 6000 rpm
Power/torque (SIEMENS)	-	17/42 kW, 183/400 Nm
Power/torque (FANUC)	-	15/20.3 kW, 143/259 Nm
<b>Feed</b>		
Rapid feed X/Y/Z	m/min	20
Cutting speed	mm/min	1-12000
<b>Accuracy (VDI3441 Full travel)</b>		
Positioning accuracy (without linear scales)	mm	0.015
Positioning repeatability (without linear scales)	mm	0.012
Positioning accuracy (with linear scales)	mm	0.120/0.010/0.010
Positioning repeatability (with linear scales)	mm	0.010/0.008/0.008
<b>Dimensions &amp; Weight</b>		
Dimensions	mm	7090×4120×4250
Weight	kg	20500

\* The above specifications are subject to change without prior notice, no liability for mistakes. Machines may be shown with optional equipment.

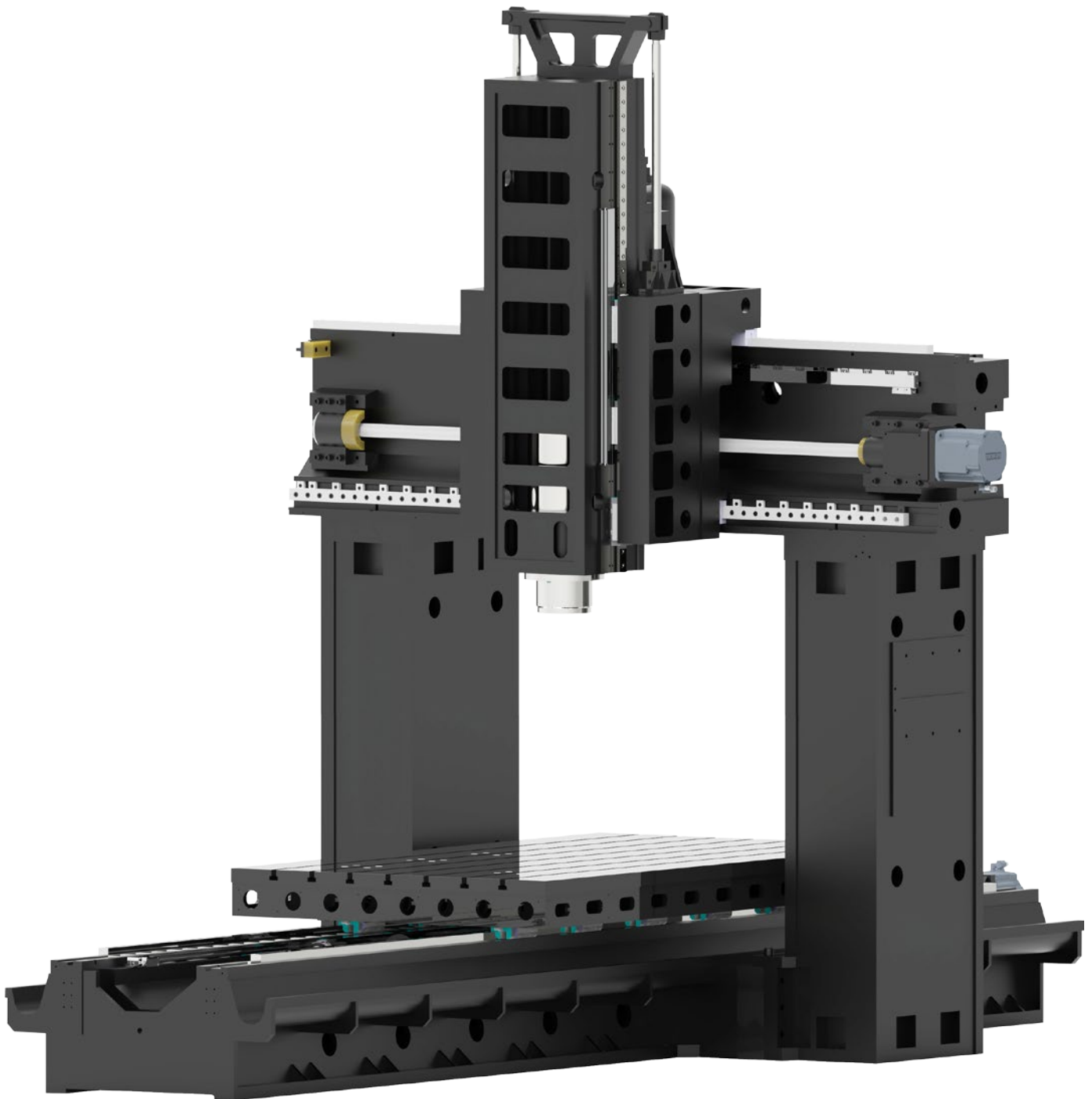

#### Standard configuration

- ✓ Fully enclosed splash guard
- ✓ Belt drive spindle 6000 rpm
- ✓ Chip conveyor (two screw type and one chain type)
- ✓ Air-conditioned electrical cabinet
- ✓ Rigid tapping
- ✓ Spindle oil cooler
- ✓ Ethernet, CF card and USB interface
- ✓ Automatic lubrication system
- ✓ Coolant system
- ✓ LED working lamp
- ✓ End of program light
- ✓ Electronic handwheel (MPG)
- ✓ Tool box
- ✓ Leveling bolts and blots
- ✓ Coolant gun
- ✓ Air gun
- ✓ User Manual

#### Optional configuration

- Built-in spindle HSK A100 12000 rpm, 20/22.5 kW, 298/346 Nm(SIEMENS)
- Built-in spindle HSK A63 18000 rpm , 30/36 kW\_85/102 Nm(SIEMENS), 60 pockets chain type tool changer
- 40 pockets chain type tool changer
- CTS coolant through spindle + ATS
- Belt drive spindle with BF gearbox
- Linear scales on X/Y/Z axis
- Extra 200GB SSD program memory (Only available on SIEMENS Control)

\* The above specifications are subject to change without prior notice, no liability for mistakes. Machines may be shown with optional equipment.



# Double Column Center V3320 · V4020



Technical Specifications		V3320	V4020
Table			
Table size	mm	3300×1700	4000×1700
T-slot (width x number x distance)	mm	22×9×170	28×11×170
Max. load	kg	10000	12000
Travel			
X/Y/Z Travel	mm	3300/2700/1000	4200/2700/1000
Spindle nose to table	mm	200-1200	
Distance between columns	mm	2000	
Spindle			
Spindle speed (Standard)	rpm	BT50/SK50, 6000 rpm	
Power/torque (SIEMENS)	-	22/60 kW, 172/380 Nm	
Power/torque (FANUC)	-	22/45 kW, 140/286 Nm	
Feed			
Rapid feed X/Y/Z	m/min	20	15/20/20
Cutting speed	mm/min	1-12000	
Accuracy (VDI3441 Full travel)			
Positioning accuracy (without linear scales)	mm	0.020/0.020/0.015	0.025/0.020/0.015
Positioning repeatability (without linear scales)	mm	0.015/0.015/0.010	0.020/0.015/0.010
Positioning accuracy (with linear scales)	mm	0.015/0.015/0.010	0.020/0.015/0.010
Positioning repeatability (with linear scales)	mm	0.010/0.010/0.006	0.015/0.010/0.006
Tool changer			
Number of tools	pcs	40/60	
Max. tool length	mm	400	
Max. tool diameter	mm	Φ125/Φ250	
Max. tool weight	kg	15	
Dimensions & Weight			
Dimensions	mm	9672×6300×5080	11692×6300×5300
Weight	kg	32000	39000

\* The above specifications are subject to change without prior notice, no liability for mistakes. Machines may be shown with optional equipment.

- Extra wide column to increase connection surface with the crossbeam to avoid vibration during cutting
- Three axes with roller type linear guideways, which offers super high rigidity and loading capacity
- Longer Y axis travel as standard to ensure more machining capacity when using 90° milling head
- Available with various spindles for different application

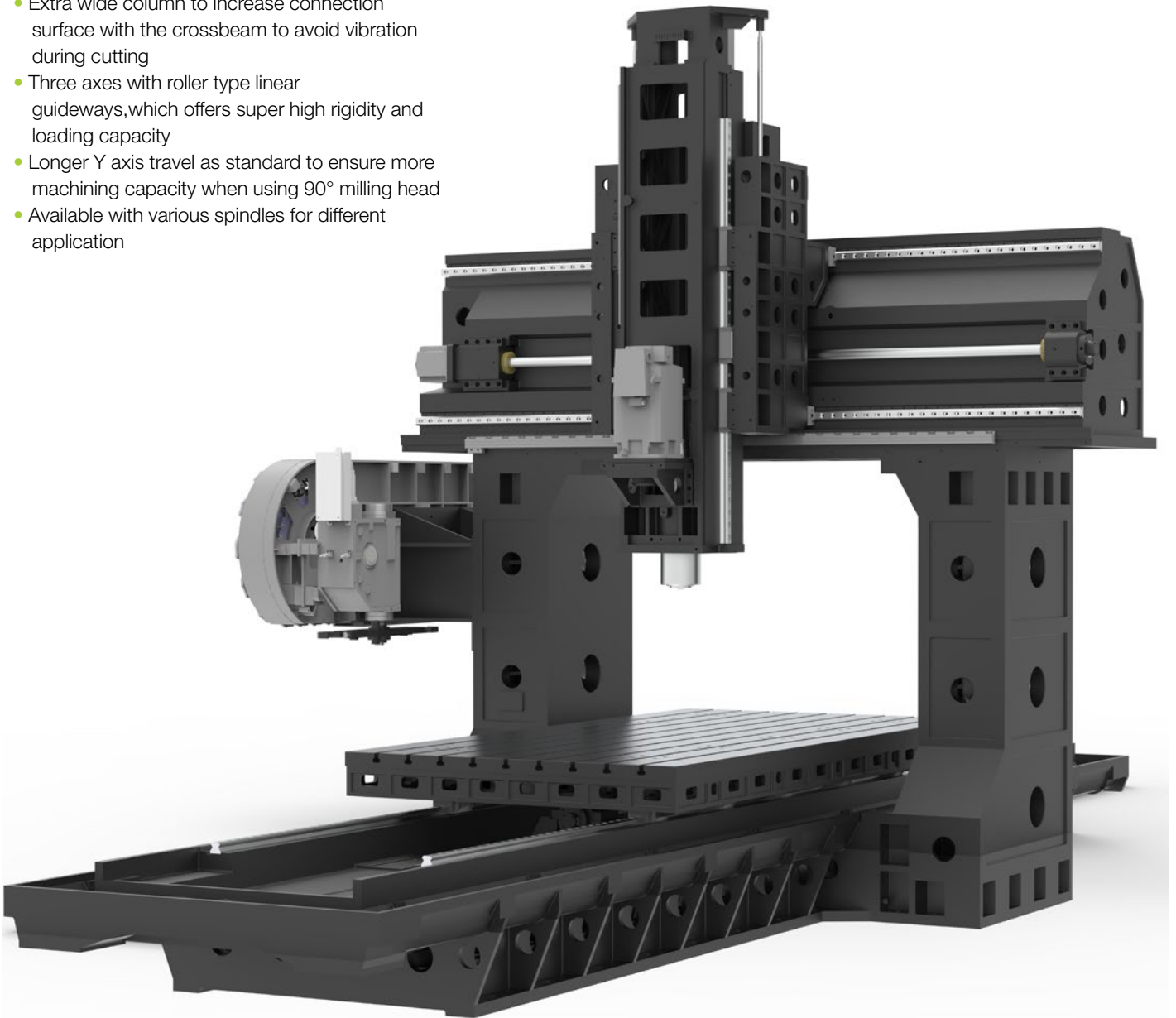

V3320 frame

## Standard configuration

- ✓ Fully enclosed splash guard
- ✓ Belt drive spindle 6000 rpm
- ✓ Chip conveyor (two screw type and one chain type)
- ✓ Air-conditioned electrical cabinet
- ✓ Rigid tapping
- ✓ Spindle oil cooler
- ✓ Ethernet, CF card and USB interface
- ✓ Automatic lubrication system
- ✓ Coolant system
- ✓ LED working lamp
- ✓ End of program light
- ✓ Electronic handwheel (MPG)
- ✓ Tool box
- ✓ Leveling bolts and blots
- ✓ Coolant gun
- ✓ Air gun
- ✓ User Manual

## Optional configuration

- Built-in spindle HSK A10012000 rpm, 20/22.5 kW, 298/346 Nm(SIEMENS)
- Built-in spindle HSK A63 18000 rpm, 26/36 kW, 124/176 Nm(SIEMENS)
- 40 pockets chain type tool changer
- 60 pockets chain type tool changer
- CTS coolant through spindle + ATS
- Belt drive spindle with BF gearbox
- Linear scales on X/Y/Z axis
- Manual 90° milling head
- Extra 200GB SSD program memory (Only available on SIEMENS Control)

\* The above specifications are subject to change without prior notice, no liability for mistakes. Machines may be shown with optional equipment.

# Double Column Center V4028

- Extra wide column to increase connection surface with the crossbeam to avoid vibration during cutting.
- Roller type linear guideway, which offers super high rigidity and loading capacity



Technical Specifications		V4028
<b>Table</b>		
Table size	mm	4000×2400
T-slot (width x number x distance)	mm	28×11×200
Max. load	kg	15000
<b>Travel</b>		
X/Y/Z Travel	mm	4200/3300/1200
Spindle nose to table	mm	250-1450
Distance between columns	mm	2800
<b>Spindle</b>		
Spindle speed	rpm	BT50, 6000 rpm
Power/torque (SIEMENS)	-	22/60 kW, 172/380 Nm
Power/torque (FANUC)	-	22/45 kW, 140/286 Nm
<b>Feed</b>		
Rapid feed X/Y/Z	m/min	12/15/20
Cutting speed	mm/min	1-12000
<b>Accuracy (VDI3441 Full travel)</b>		
Positioning accuracy (without linear scales)	mm	0.025/0.020/0.015
Positioning repeatability (without linear scales)	mm	0.020/0.015/0.010
Positioning accuracy (with linear scales)	mm	0.020/0.015/0.010
Positioning repeatability (with linear scales)	mm	0.015/0.010/0.006
<b>Tool changer</b>		
Number of tools	pcs	40/60
Max. tool length	mm	400
Max. tool diameter	mm	Φ125/Φ250
Max. tool weight	kg	15
<b>Dimensions &amp; Weight</b>		
Dimensions	mm	11980×6751×5920
Weight	kg	50000

\* The above specifications are subject to change without prior notice, no liability for mistakes. Machines may be shown with optional equipment.



- Z axis designed with dual drive technology two ballscrews for high dynamic machining
- 4 linear guideways on Z axis ensure high rigidity and high accuracy
- 3 linear guideways on Y axis
- 3 linear guideways support the base
- High rigid column structure

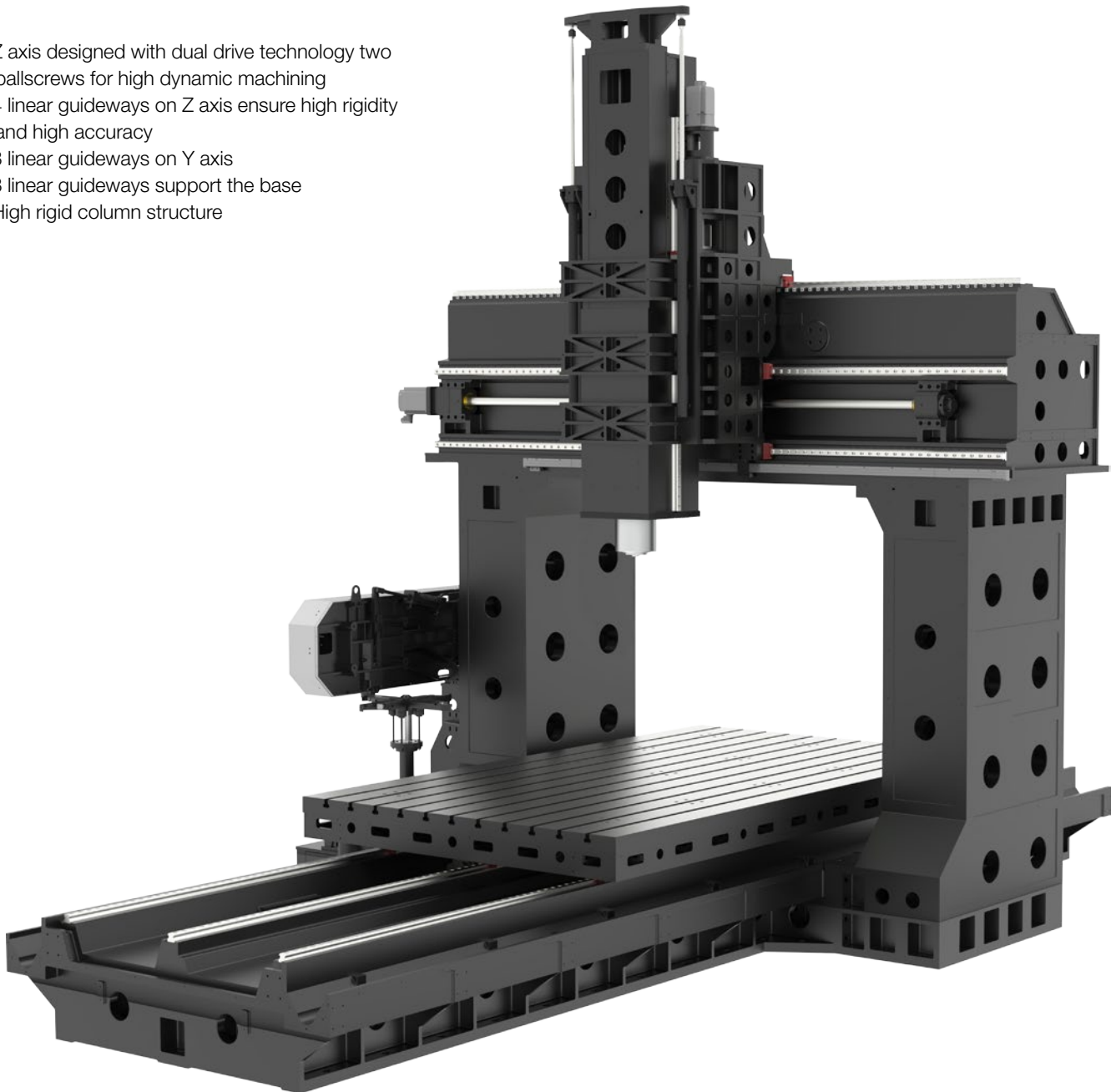

V4028 frame

#### Standard configuration

- ✓ Fully enclosed splash guard
- ✓ Belt drive spindle 6000 rpm
- ✓ Chip conveyor (two screw type and one chain type)
- ✓ Air-conditioned electrical cabinet
- ✓ Rigid tapping
- ✓ Spindle oil cooler
- ✓ Ethernet, CF card and USB interface
- ✓ Automatic lubrication system
- ✓ Coolant system
- ✓ LED working lamp
- ✓ End of program light
- ✓ Electronic handwheel (MPG)
- ✓ Tool box
- ✓ Leveling bolts and blots
- ✓ Coolant gun
- ✓ Air gun
- ✓ User Manual

#### Optional configuration

- Built-in spindle HSK A100 12000 rpm, 20/22.5 kW, 298/346 Nm(SIEMENS)
- 40 pockets chain type tool changer
- 60 pockets chain type tool changer
- CTS coolant through spindle + ATS
- Belt drive spindle with BF gearbox
- Linear scales on X/Y/Z axis
- Manual 90° milling head
- Extra 200GB SSD program memory (Only available on SIEMENS Control)

\* The above specifications are subject to change without prior notice, no liability for mistakes. Machines may be shown with optional equipment.



SIEMENS



HEIDENHAIN



FANUC



MITSUBISHI

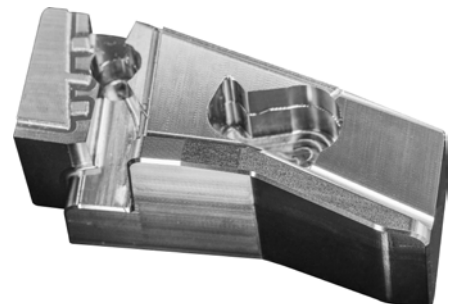
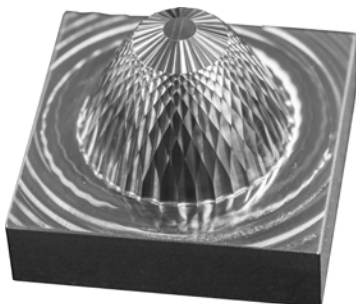
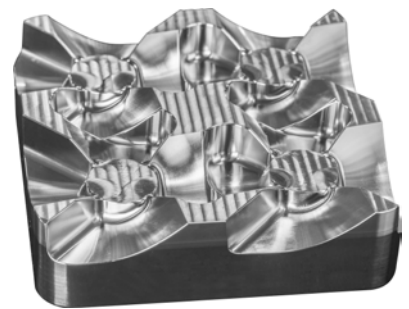
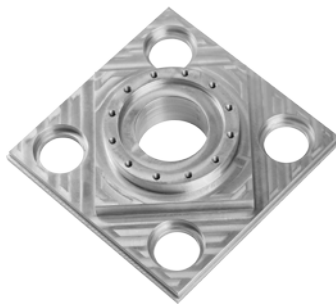
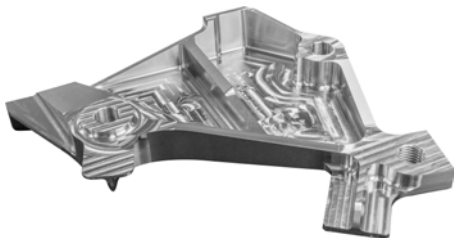
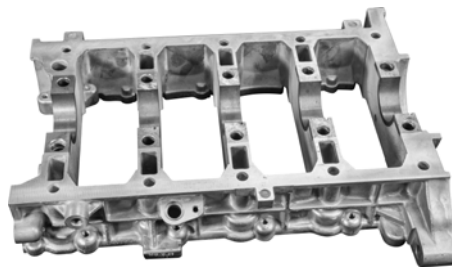
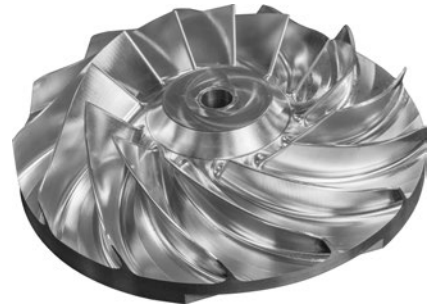





**hyperMILL<sup>®</sup>**  
**SolidCAM**  
 The Leaders in Integrated CAM



**DIJET NS TOOL**  
**GÜHRING**



**LEHMANN<sup>®</sup>**



**HAIMER**



**SCHUNK**



**Blaser.**  
 SWISSLUBE

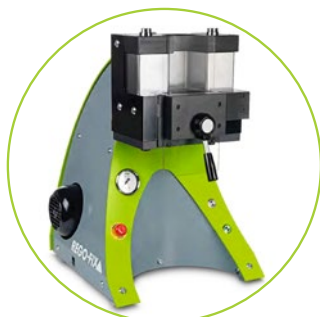

**REGO-FIX**



**BLUM**  
 focus on productivity

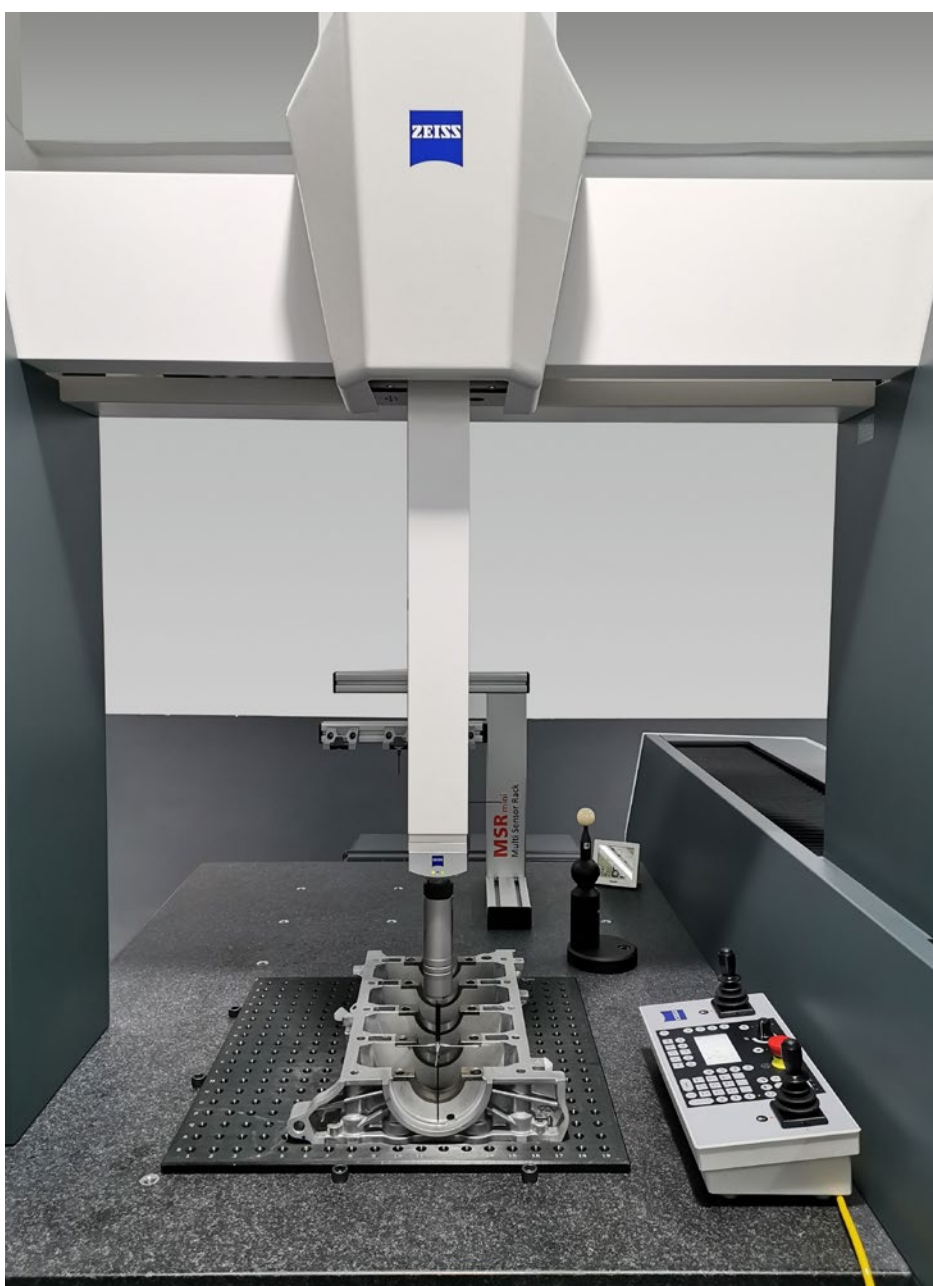

Workpiece measuring by CMM

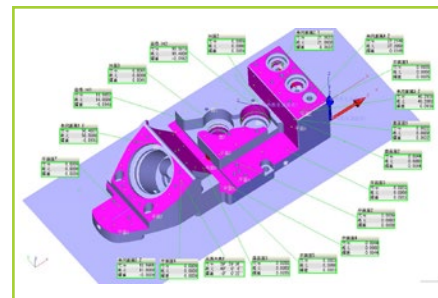
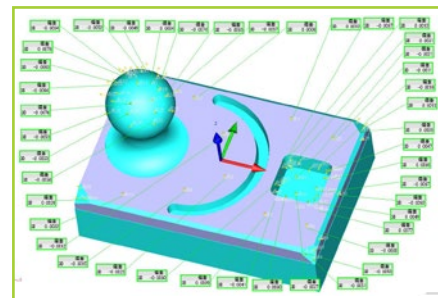
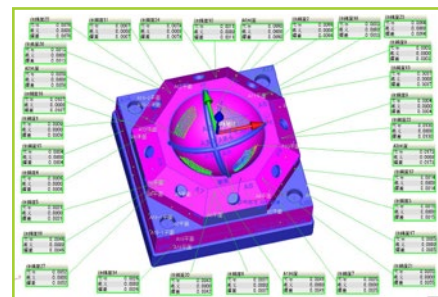
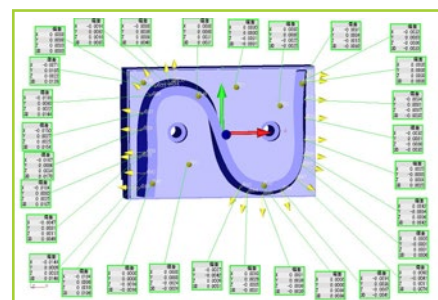

\* The above specifications are subject to change without prior notice, no liability for mistakes. Machines may be shown with optional equipment.

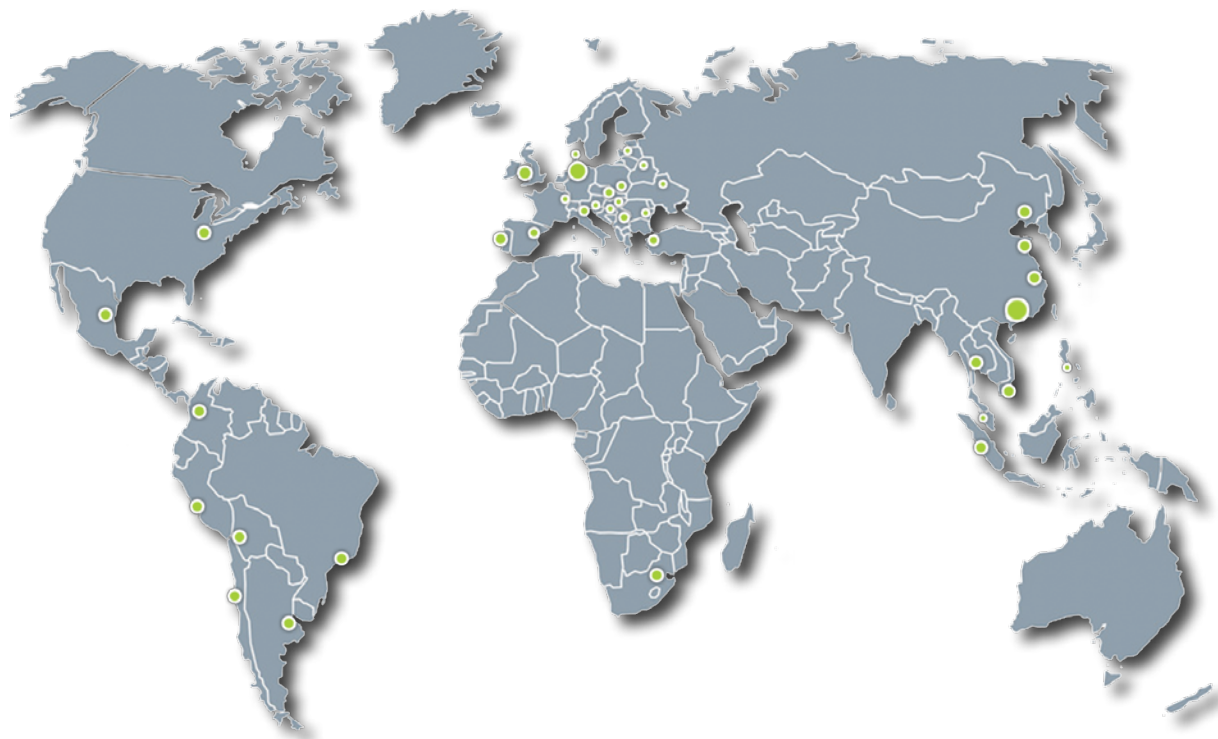

**PRIMINER Werkzeugmaschinen GmbH**

Tungendorfer Str.10 · D-24536 Neumünster/Germany

Tel: +49 (0) 4321-53 9946-0

Fax: +49 (0) 4321-25 20 03 -90

E-mail: [info@priminer.de](mailto:info@priminer.de)

**PRIMINER SOUTH EAST EUROPE · PRIMINER d.o.o. BEOGRAD**

Vladimira Popovica 38-40 · GTC - 11070 Beograd/Srbija

Tel: +381 69 702 705

Fax: +381 11 715 69 00

E-mail: [office@priminer.de](mailto:office@priminer.de)

**PRIMINER MACHINE TOOLS DONGGUAN CO., LTD**

XinRuYi Industrial Park, Fuxing Road, Xingguang Village, Huangjiang Town, Dongguan, P.R.China

Tel: +86 769 838 490 61

Fax: +86 769 838 490 62

E-mail: [sales@priminer.de](mailto:sales@priminer.de)

[www.priminer.de](http://www.priminer.de)